

REPUBLIC  
OF  
SOUTH AFRICA



REPUBLIEK  
VAN  
SUID-AFRIKA

# Government Gazette Staatskoerant

Vol. 390

PRETORIA, 17 DECEMBER 1997  
DESEMBER

No. 18558

## GOVERNMENT NOTICE GOEWERMENTSKENNISGEWING

### DEPARTMENT OF TRANSPORT DEPARTEMENT VAN VERVOER

No. 1733

17 December 1997

**PROCLAMATION OF ALTERNATIVE ROUTES AS PART OF NATIONAL ROUTE 3 SECTIONS 6 AND 8 AS WELL AS THE AMENDMENT OF PROCLAMATIONS BY MEANS OF WHICH THE ABOVE ROUTES WERE PROCLAIMED AS NATIONAL ROADS IN ORDER TO EFFECT WIDENINGS OF THE PROCLAIMED ROAD RESERVE: PROVINCES OF KWAZULU-NATAL AND FREE STATE**

By virtue of section 4 (1) (a) of the National Roads Act, 1971 (Act No. 54 of 1971), as amended, I hereby declare that the routes as shown on the subjoined Plans P409/97 and P410/97 shall be national roads, and by virtue of section 4 (1) (c) of the same Act, I hereby amend Proclamations Nos.—

- 2401 of 1989 (National Route 3 Section 6, Keeversfontein–Bramhoek) by substituting the subjoined sheets 4A and 5A for sheets 4 and 5 respectively of Plan 251/89;
- 2398 of 1989 (National Route 3 Section 6, Bramhoek–De Jagersrust) by substituting the subjoined sheets 1A and 5A for sheets 1 and 5 respectively of Plan P249/89; and
- 2028 of 1990 (National Route 3 Section 8, Buckland Downs–Klipdrift) by substituting the subjoined sheets 3A and 5A for sheets 3 and 5 respectively of Plan 244/90.

**M. MAHARAJ**  
Minister of Transport

No. 1733

17 Desember 1997

**VERKLARING VAN ALTERNATIEWE ROETES AS DEEL VAN NASIONALE ROETE 3 SEKSIES 6 EN 8 SOWEL AS DIE WYSIGING VAN DIE PROKLAMASIES WAARKRAGTENS DIE GENOEMDE ROETES AS NASIONALE PAAIE VERKLAAR IS, TEN EINDE VERBREIDING VAN DIE GEPROKLAMEERDE PADRESERWE TE BEWERKSTELLIG: PROVINSIES VAN KWAZULU-NATAL EN DIE VRYSTAAT**

Kragtens artikel 4 (1) (a) van die Wet op Nasionale Paaie, 1971 (Wet No. 54 van 1971), soos gewysig, verklaar ek hierby dat die roetes soos getoon op meegaande Planne P409/97 en P410/97 'n nasionale paaie is; en kragtens artikel 4 (1) (c) van genoemde Wet, wysig ek hierby Proklamasie Nos.—

- 2401 van 1989 (Nasionale Roete 3 Seksie 6, Keeversfontein–Bramhoek) deur velle 4 en 5 van Plan 251/89 respektiewelik te vervang met bygaande velle 4A en 5A;
- 2398 van 1989 (Nasionale Roete 3 Seksie 6, Bramhoek–De Jagersrust) deur velle 1 en 5 van Plan P249/89 respektiewelik te vervang met bygaande velle 1A en 5A; en
- 2028 van 1990 (Nasionale Roete 3 Seksie 8, Buckland Downs–Klipdrift), deur velle 3 en 5 van Plan 244/90 respektiewelik te vervang met bygaande velle 3A en 5A.

M. MAHARAJ

Minister van Vervoer

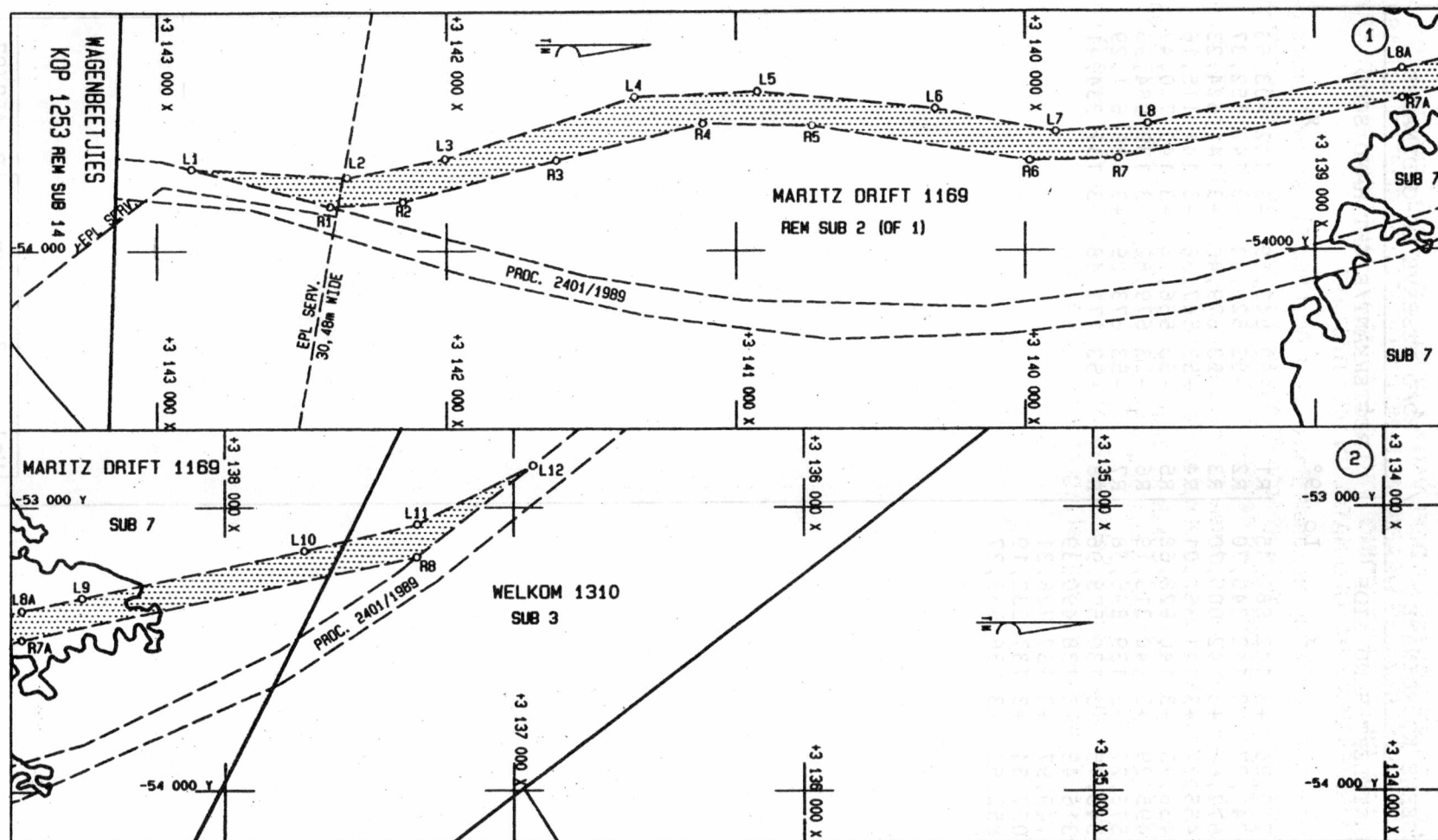

Suid-Afrikaanse Padraad  
South African Roads Board

Die figuur getoon  
The figure shown



stel die padreserve voor van 'n gedeelte  
represents the road reserve of a portion  
van Nasionale Roete  
of National Route  
N3  
Seksie  
Section  
6

Vel  
Sheet  
1  
of  
2  
P 409/97

PADRESERWE KOÖRDINATE				/	ROAD RESERVE CO-ORDINATES			
LINKERKANT/LEFT HAND SIDE					REGTERKANT/RIGHT HAND SIDE			
	Y	X	Lo 29°			Y	X	
L1	-53 710,84	+3 142 882,45		R1	-53 843,39	+3 142 403,63		
L2	-53 740,97	+3 142 346,70		R2	-53 826,44	+3 142 152,87		
L3	-53 673,68	+3 142 005,70		R3	-53 679,46	+3 141 624,23		
L4	-53 455,22	+3 141 353,01		R4	-53 547,36	+3 141 115,16		
L5	-53 436,73	+3 140 928,68		R5	-53 556,26	+3 140 740,47		
L6	-53 495,29	+3 140 313,19		R6	-53 679,82	+3 139 984,96		
L7	-53 576,27	+3 139 895,38		R7	-53 673,09	+3 139 681,29		
L8	-53 548,75	+3 139 578,96		R8	-53 171,48	+3 137 334,41		
L9	-53 316,45	+3 138 490,39						
L10	-53 149,97	+3 137 726,31						
L11	-53 057,54	+3 137 332,19						
L12	-52 852,62	+3 136 933,37						

Vel  
Sheet

2

van 2  
of

P 409/97



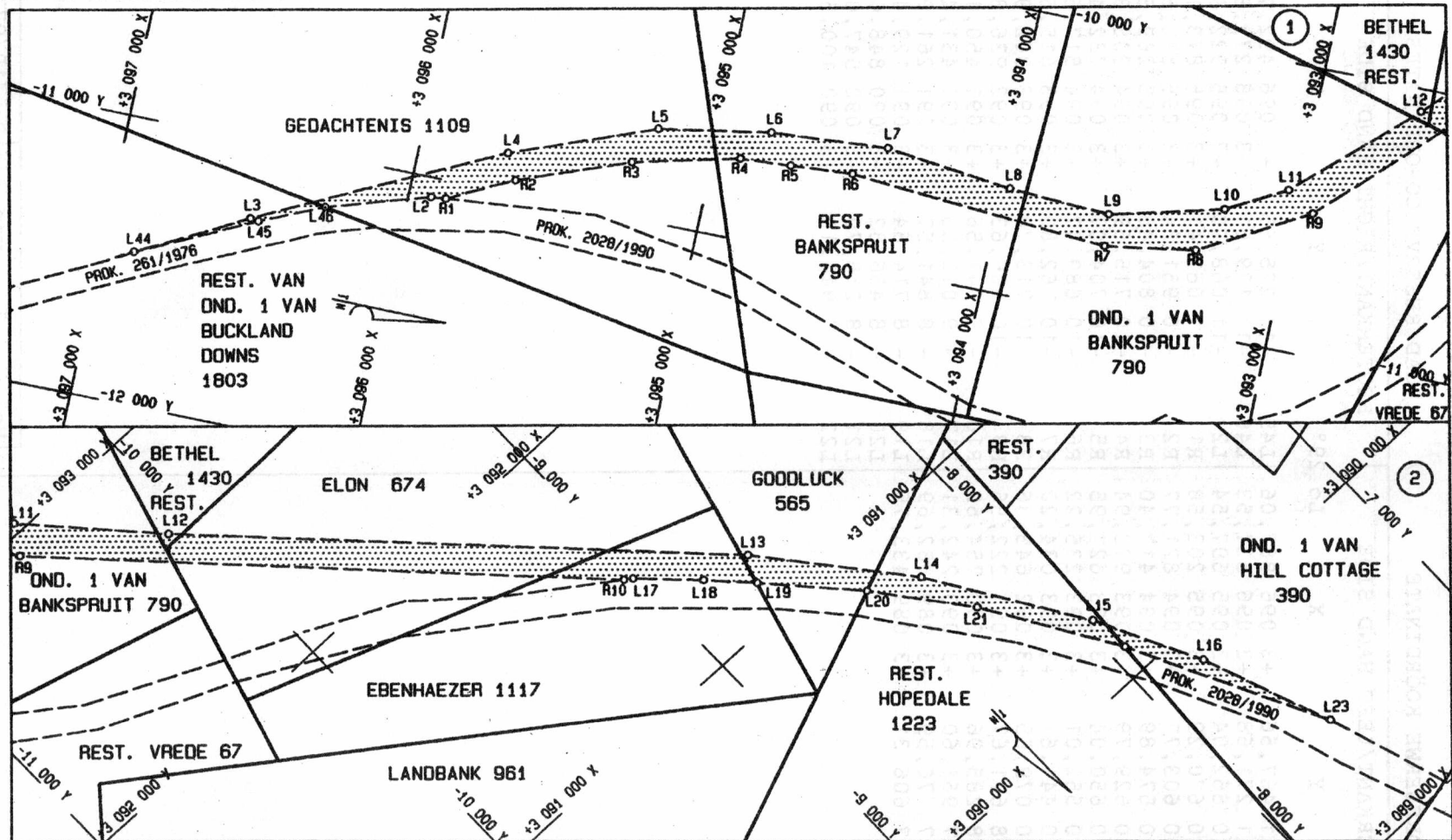

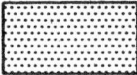
<p>Suid-Afrikaanse Padraad South African Roads Board</p>	<p>Die figuur getoon The figure shown</p> 	<p>stel die padreserwe voor van 'n gedeelte represents the road reserve of a portion van Nasionale Roete of National Route</p> <p>N3</p> <p>Seksie Section</p> <p>8</p>	<p>Vel Sheet</p> <p>1 van 2</p> <p>P 410/97</p>
--------------------------------------------------------------	------------------------------------------------------------------------------------------------------------------------------------	-----------------------------------------------------------------------------------------------------------------------------------------------------------------------------------------	-----------------------------------------------------

PADRESERWE KOÖRDINATE				/	ROAD RESERVE CO-ORDINATES			
LINKERKANT/LEFT HAND SIDE					REGTERKANT/RIGHT HAND SIDE			
	Y	X	Lo 29°			Y	X	
L44	-11 467,56	+3 096 887,06		L45	-11 275,55	+3 096 492,74		
L3	-11 271,68	+3 096 521,53		L46	-11 179,61	+3 096 272,89		
L4	-10 862,04	+3 095 697,54		L2	-11 068,20	+3 095 922,98		
L5	-10 670,29	+3 095 203,58		R1	-11 063,41	+3 095 873,15		
L6	-10 603,77	+3 094 821,77		R2	-10 951,34	+3 095 652,54		
L7	-10 574,89	+3 094 413,40		R3	-10 804,48	+3 095 269,54		
L8	-10 629,79	+3 093 973,94		R4	-10 715,59	+3 094 908,32		
L9	-10 650,04	+3 093 622,95		R5	-10 704,07	+3 094 732,45		
L10	-10 552,01	+3 093 235,22		R6	-10 689,47	+3 094 517,62		
L11	-10 441,61	+3 093 034,20		R7	-10 762,80	+3 093 615,59		
L12	-10 079,65	+3 092 645,36		R8	-10 713,70	+3 093 302,93		
L13	- 8 671,67	+3 091 222,56		R9	-10 506,63	+3 092 936,83		
L14	- 8 285,96	+3 090 754,62		R10	- 9 041,56	+3 091 450,11		
L15	- 7 961,60	+3 090 242,31		L17	- 9 015,35	+3 091 431,49		
L16	- 7 776,59	+3 089 882,69		L18	- 8 841,57	+3 091 261,91		
L23	- 7 606,31	+3 089 433,75		L19	- 8 714,64	+3 091 129,49		
				L20	- 8 456,82	+3 090 848,69		
				L21	- 8 218,70	+3 090 547,00		
				L22	- 7 943,10	+3 090 100,55		

Vel  
Sheet

2

van 2  
of

P 410/97

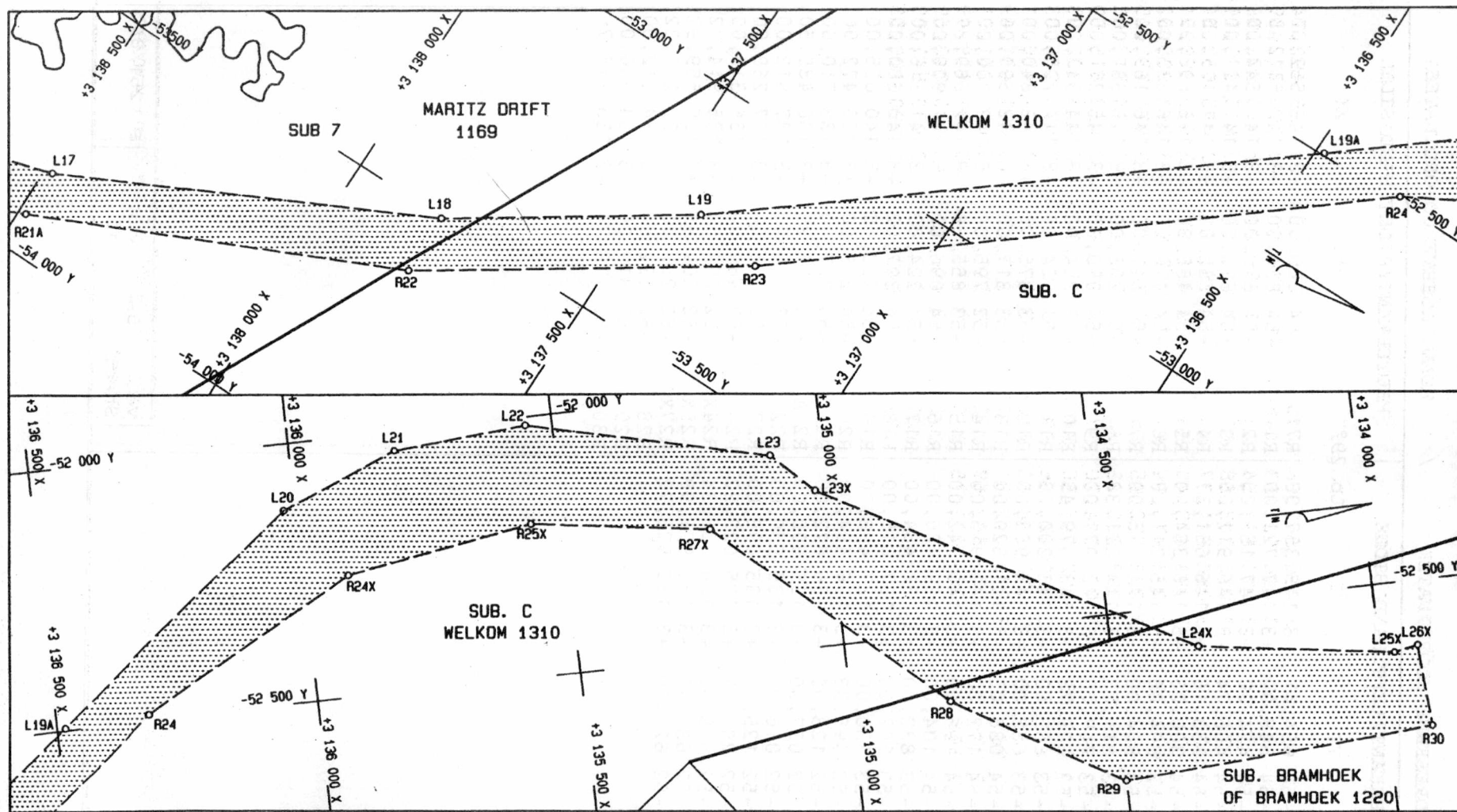

<p>Suid-Afrikaanse Padraad South African Roads Board</p>	<p>Die figuur getoon The figure shown</p> <div data-bbox="863 1328 1017 1410" style="border: 1px solid black; width: 72px; height: 50px; background-color: #cccccc; margin: 10px auto;"></div>	<p>stel die padreserwe voor van 'n gedeelte represents the road reserve of a portion van Nasionale Roete of National Route</p> <p>N3</p> <p>Seksie Section</p> <p>6</p>	<p>Vel Sheet</p> <p>4A van of 5</p> <p>P 251/89</p>
--------------------------------------------------------------	----------------------------------------------------------------------------------------------------------------------------------------------------------------------------------------------------	-----------------------------------------------------------------------------------------------------------------------------------------------------------------------------------------	-------------------------------------------------------------

PADRESERWE KOÖRDINATE				/	ROAD RESERVE CO-ORDINATES			
LINKERKANT/LEFT HAND SIDE					REGTERKANT/RIGHT HAND SIDE			
	Y	X	Lo 29°			Y	X	
L66B	-54 654,41	+3 148 357,98		R71	-54 860,00	+3 148 552,00		
L1	-54 548,00	+3 147 721,00		R1	-54 834,00	+3 148 511,40		
L2	-54 424,00	+3 147 152,00		R2	-54 612,00	+3 147 544,00		
L3	-54 406,74	+3 146 912,00		R3	-54 612,00	+3 147 421,00		
L4	-54 333,16	+3 146 661,37		R4	-54 552,00	+3 147 105,00		
L5	-54 300,00	+3 146 384,00		R5	-54 485,30	+3 146 896,92		
L6	-53 894,00	+3 145 211,00		R6	-54 470,00	+3 146 635,00		
L7	-53 804,00	+3 144 775,00		R7	-54 342,00	+3 146 169,00		
L8	-53 811,73	+3 144 231,38		R8	-54 288,00	+3 145 887,00		
L9	-53 747,00	+3 143 977,00		R9	-54 050,00	+3 145 375,00		
L10	-53 699,78	+3 143 579,49		R10	-53 934,00	+3 144 943,00		
L11	-53 665,00	+3 143 200,00		R11	-53 904,00	+3 144 205,00		
L12	-53 683,00	+3 142 983,00		R12	-53 875,00	+3 143 840,00		
L13	-54 088,00	+3 141 520,00		R13	-53 817,00	+3 143 690,00		
L14	-54 172,00	+3 140 975,00		R14	-53 795,00	+3 143 300,00		
L15	-54 196,00	+3 140 142,00		R15	-53 855,38	+3 142 669,87		
L16	-54 104,00	+3 139 420,00		R16	-54 096,00	+3 141 900,00		
L17	-53 832,00	+3 138 484,00		R17	-54 224,00	+3 141 316,00		
L18	-53 502,00	+3 137 815,00		R18	-54 307,00	+3 140 680,00		
L19	-53 230,00	+3 137 408,00		R19	-54 290,00	+3 140 055,00		
L19A	-52 495,33	+3 136 484,00		R20	-54 218,00	+3 139 472,00		
L20	-52 128,00	+3 136 022,00		R21	-54 027,00	+3 138 710,00		
L21	-52 037,00	+3 135 800,00		R21A	-53 925,25	+3 138 485,50		
L22	-52 016,00	+3 135 550,00		R22	-53 620,00	+3 137 812,00		
L23	-52 125,00	+3 135 098,00		R23	-53 258,00	+3 137 268,00		
L23X	-52 201,47	+3 135 022,22		R24	-52 489,00	+3 136 318,00		
L24X	-52 578,95	+3 134 336,34		R24X	-52 264,54	+3 135 914,72		
L25X	-52 632,47	+3 133 971,98		R25X	-52 204,95	+3 135 559,92		
L26X	-52 623,89	+3 133 926,72		R27X	-52 252,76	+3 135 225,32		
				R28	-52 632,00	+3 134 812,00		
				R29	-52 819,00	+3 134 500,00		
				R30	-52 778,74	+3 133 915,75		

Vel  
Sheet

5A

van 5  
of

P 251/89



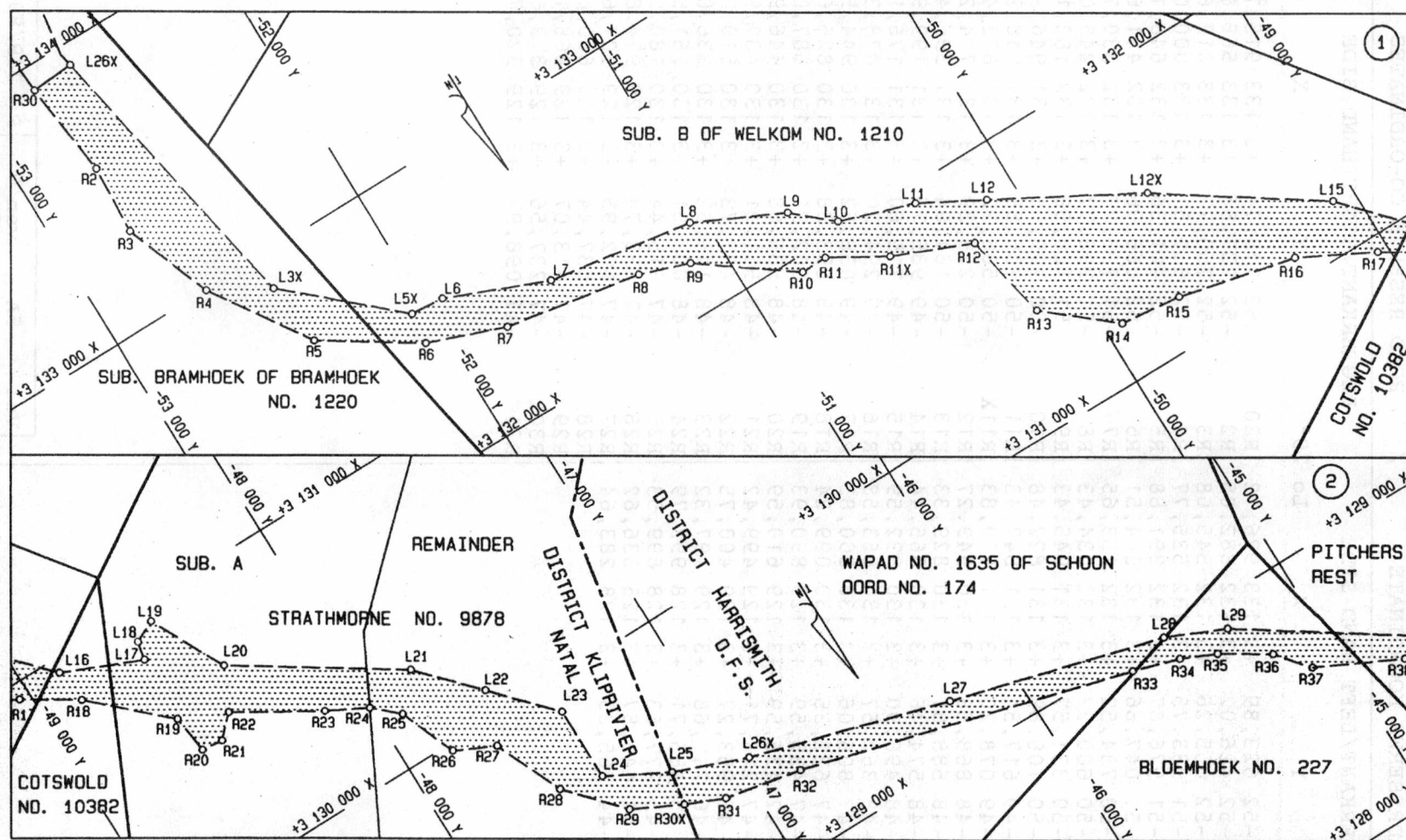

<p>Suid-Afrikaanse Padraad South African Roads Board</p>	<p>Die figuur getoon The figure shown</p>	<p>stel die padreserve voor van 'n gedeelte represents the road reserve of a portion van Nasionale Roete N3 of National Route</p> <p>Seksie 6 &amp; 7 Section</p>	<p>Vel 1A van 7 Sheet of</p> <p>P 249/89</p>
--------------------------------------------------------------	-----------------------------------------------	-----------------------------------------------------------------------------------------------------------------------------------------------------------------------------------	--------------------------------------------------

PADRESERWE KOÖRDINATE				/	ROAD RESERVE CO-ORDINATES			
LINKERKANT/LEFT HAND SIDE					REGTERKANT/RIGHT HAND SIDE			
	Y	X	Lo 29°			Y	X	
L26X	-52 623,89	+3 133 926,72		R30	-52 778,74	+3 133 915,75		
L3X	-52 426,02	+3 132 882,05		R2	-52 737,86	+3 133 565,83		
L5X	-52 055,26	+3 132 545,68		R3	-52 750,77	+3 133 317,68		
L6	-51 933,75	+3 132 535,77		R4	-52 631,51	+3 133 000,04		
L7	-51 576,87	+3 132 391,88		R5	-52 401,36	+3 132 648,18		
L8	-51 047,66	+3 132 304,51		R6	-52 066,96	+3 132 431,65		
L9	-50 734,52	+3 132 153,65		R7	-51 793,27	+3 132 330,72		
L10	-50 600,29	+3 132 034,43		R8	-51 298,77	+3 132 245,08		
L11	-50 331,57	+3 131 945,43		R9	-51 120,58	+3 132 182,16		
L12	-50 108,89	+3 131 822,48		R10	-50 799,56	+3 131 946,91		
L12X	-49 617,54	+3 131 547,43		R11	-50 705,55	+3 131 948,22		
L15	-49 078,20	+3 131 179,83		R11X	-50 508,22	+3 131 832,40		
L16	-48 868,58	+3 130 949,27		R12	-50 225,39	+3 131 714,27		
L17	-48 588,81	+3 130 829,33		R13	-50 164,84	+3 131 395,40		
L18	-48 574,46	+3 130 865,44		R14	-49 935,76	+3 131 199,95		
L19	-48 496,90	+3 130 932,59		R15	-49 715,60	+3 131 176,16		
L20	-48 362,57	+3 130 663,58		R16	-49 294,20	+3 131 078,36		
L21	-47 806,06	+3 130 300,83		R17	-49 038,52	+3 130 944,52		
L22	-47 622,35	+3 130 099,24		R18	-48 853,38	+3 130 825,67		
L23	-47 435,59	+3 129 890,93		R19	-48 602,91	+3 130 587,00		
L24	-47 435,59	+3 129 619,59		R20	-48 586,68	+3 130 446,90		
L25	-47 213,71	+3 129 499,42		R21	-48 511,21	+3 130 437,98		
L26X	-46 953,27	+3 129 400,75		R22	-48 437,73	+3 130 510,90		
L27	-46 241,68	+3 129 197,32		R23	-48 145,92	+3 130 336,00		
L28	-45 485,71	+3 128 992,79		R24	-48 003,51	+3 130 261,54		
L29	-45 277,63	+3 128 899,53		R25	-47 915,44	+3 130 180,99		
L30	-44 446,87	+3 128 336,62		R26	-47 833,74	+3 129 974,88		
L31	-44 265,33	+3 128 283,64		R27	-47 692,95	+3 129 907,63		
				R28	-47 587,44	+3 129 660,85		
				R29	-47 413,07	+3 129 468,10		
				R30X	-47 237,56	+3 129 379,64		
				R31	-47 098,97	+3 129 320,79		

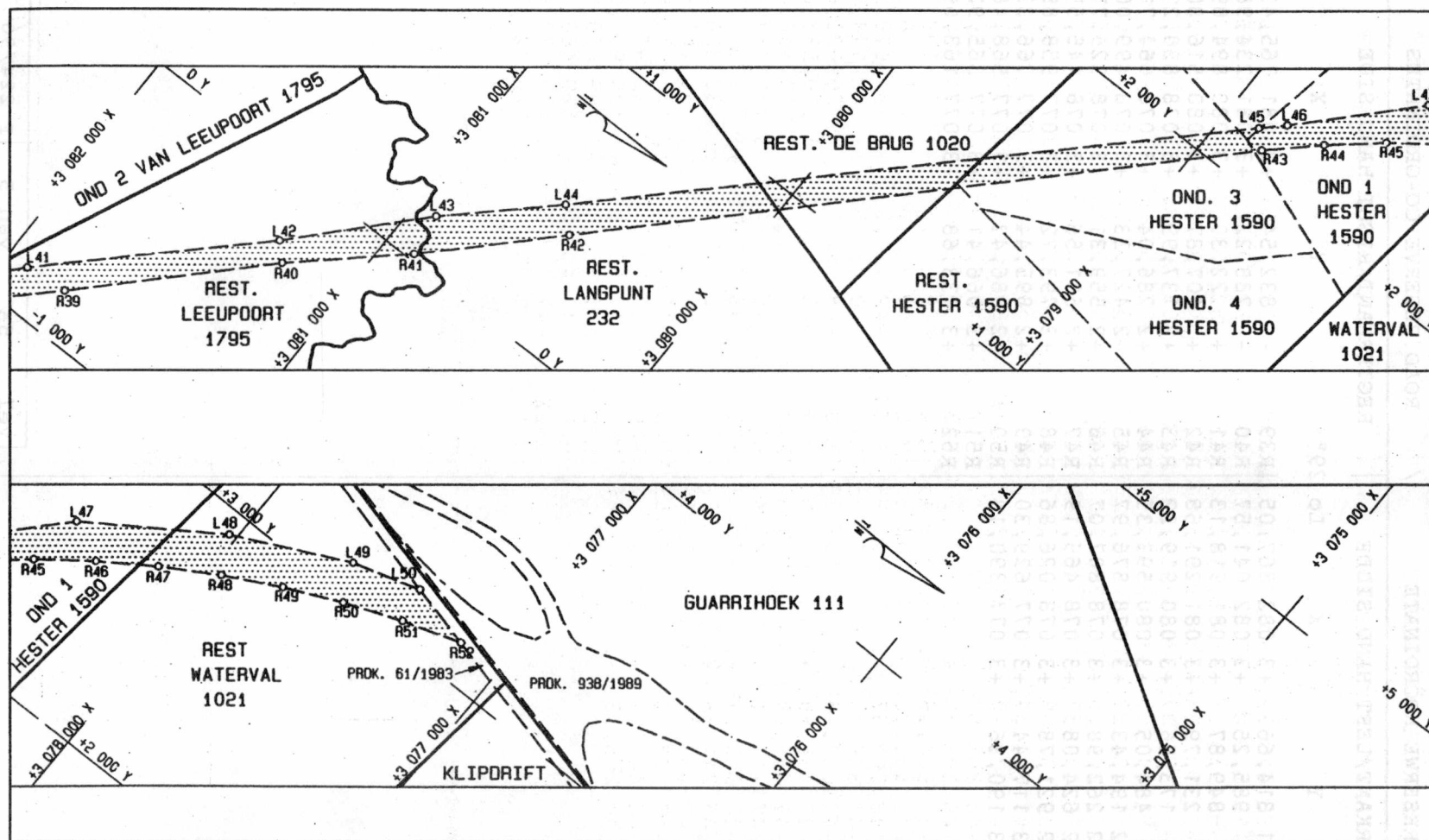

<p>Suid-Afrikaanse Padraad South African Roads Board</p>	<p>Die figuur getoon The figure shown</p>	<p>stel die padreserwe voor van 'n gedeelte represents the road reserve of a portion van Nasionale Roete N3 of National Route N3</p>	<p>Vel Sheet 3A van of 5 P 224/90</p>
--------------------------------------------------------------	-----------------------------------------------	--------------------------------------------------------------------------------------------------------------------------------------------------	-------------------------------------------

PADRESERVE KOÖRDINATE				/ ROAD RESERVE CO-ORDINATES			
LINKERKANT/LEFT HAND SIDE				REGTERKANT/RIGHT HAND SIDE			
	Y	X	Lo 29°		Y	X	
L39	-1 814,66	+3 082 867,05		R39	- 832,54	+3 081 765,43	
L40	- 985,25	+3 082 041,57		R40	- 288,22	+3 081 234,98	
L41	- 849,87	+3 081 918,13		R41	+ 22,30	+3 080 894,89	
L42	- 231,79	+3 081 291,68		R42	+ 407,87	+3 080 516,80	
L43	+ 173,56	+3 080 919,29		R43	+2 137,99	+3 078 820,27	
L44	+ 484,05	+3 080 593,35		R44	+2 286,04	+3 078 664,71	
L45	+2 194,43	+3 078 876,97		R45	+2 427,33	+3 078 499,00	
L46	+2 262,98	+3 078 807,07		R46	+2 559,31	+3 078 325,77	
L47	+2 624,08	+3 078 465,19		R47	+2 681,56	+3 078 145,55	
L48	+2 921,78	+3 078 026,86		R48	+2 793,72	+3 077 958,88	
L49	+3 117,44	+3 077 629,30		R49	+2 895,44	+3 077 766,33	
L50	+3 190,36	+3 077 390,18		R50	+2 986,43	+3 077 568,48	
				R51	+3 066,41	+3 077 365,92	
				R52	+3 133,68	+3 077 163,65	

Vel  
Sheet

5A

van 5  
of

P 224/90



*Looking for back copies and out of print issues of  
the Government Gazette and Provincial Gazettes?*

## The State Library has them!

Let us make your day with the information you need ...

The State Library Reference and Information Service  
PO Box 397  
0001 PRETORIA  
Tel./Fax (012) 321-8931  
E-mail: [infodesk@statelib.pwv.gov.za](mailto:infodesk@statelib.pwv.gov.za)

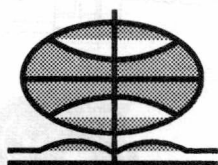

*Soek u ou kopieë en uit druk uitgawes van die  
Staatskoerant en Provinsiale Koerante?*

## Die Staatsbiblioteek het hulle!

Met ons hoef u nie te sukkel om inligting te bekom nie ...

Die Staatsbiblioteek Naslaan- en Inligtingdiens  
Posbus 397  
0001 PRETORIA  
Tel./Faks (012) 321-8931  
E-pos: [infodesk@statelib.pwv.gov.za](mailto:infodesk@statelib.pwv.gov.za)

# SA WEATHER BUREAU SA WEERBURO

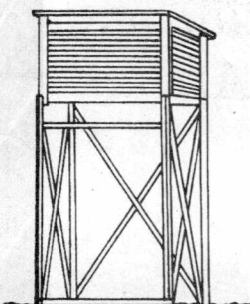
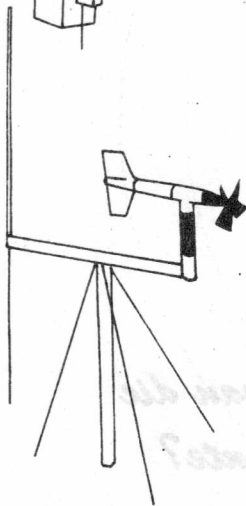

**W  
E  
A  
T  
H  
E  
R  
·  
S  
E  
R  
V  
I  
C  
E  
S  
·  
W  
E  
E  
R  
D  
I  
E  
N  
S  
T  
E**

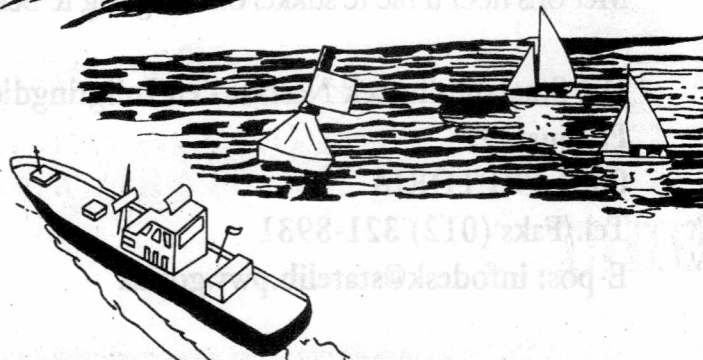
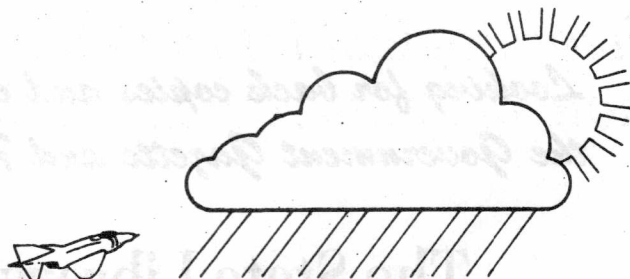

*Where is the largest amount of meteorological information in the whole of South Africa available?*

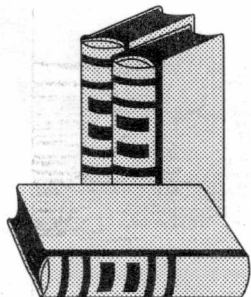
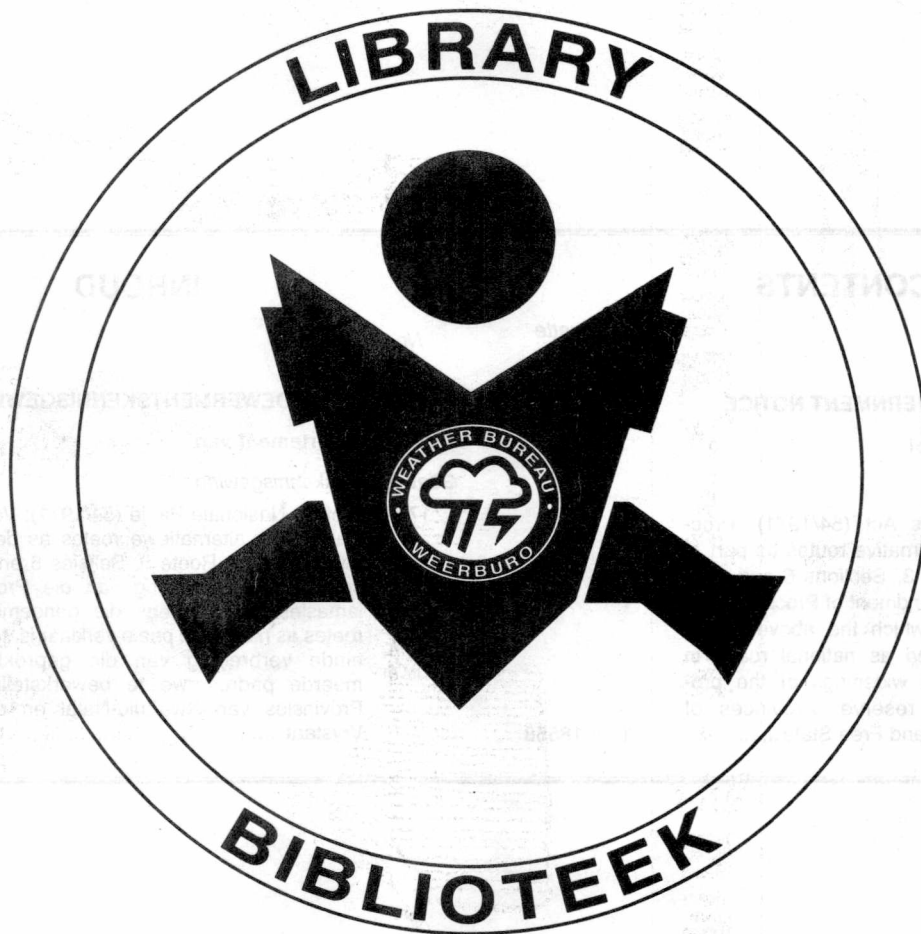
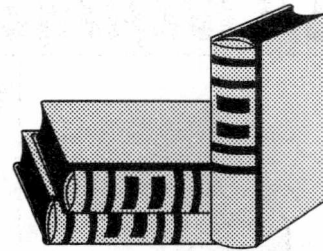

*Waar is die meeste weerkundige inligting in die hele Suid-Afrika beskikbaar?*

**CONTENTS****INHOUD**

No.	Page No.	Gazette No.	No.	Bladsy No.	Koerant No.
<b>GOVERNMENT NOTICE</b>			<b>GOEWERMENSKENNISGEWING</b>		
<b>Transport, Department of</b>			<b>Vervoer, Departement van</b>		
<i>Government Notice</i>			<i>Goewermenskennisgewing</i>		
1733			1733		
National Roads Act (54/1971): Proclamation of alternative routes as part of National Route 3, Sections 6 and 8 as well as the amendment of Proclamations by means of which the above routes were proclaimed as national roads in order to effect widenings of the proclaimed road reserve: Provinces of Kwazulu-Natal and Free State .....			Wet op Nasionale Paaie (54/1971): Verklaring van alternatiewe roetes as deel van Nasionale Roete 3, Seksies 6 en 8 sowel as die wysiging van die Proklamasies waarkragtens die genoemde roetes as nasionale paaie verklaar is, ten einde verbreding van die geprokla-meerde padreserwe te bewerkstellig: Provinsies van KwaZulu-Natal en die Vrystaat .....		
	1	18558		2	18558