



GOVERNMENT GAZETTE

OF THE

REPUBLIC OF NAMIBIA

N\$5.40

WINDHOEK - 1 December 2009

No. 4386

CONTENTS

	<i>Page</i>
GOVERNMENT NOTICES	
No. 229 Windhoek Town Planning Amendment Scheme No. 89: Town Planning Ordinance, 1954.....	2
No. 230 Ongwediva Town Planning Amendment Scheme No. 4: Town Planning Ordinance, 1954	2
No. 231 Notice of intended amendment of tariff of consulting fees chargeable by Professional Engineers and Incorporated Engineers: Engineering Profession Act, 1986	3
No. 232 Minimum fees chargeable by Architects and Quantity Surveyors: Architects and Quantity Surveyors' Act, 1979	3
No. 233 Alteration of boundaries of the Local Authority Area of Opuwo: Local Authorities Act, 1992	4
No. 234 Regulations relating to fees payable to Bank of Namibia: Banking Institutions Act, 1998	5
No. 235 Aliens Act, 1937: Change of surname	6
GENERAL NOTICES	
No. 320 Municipality of Grootfontein: Notice of vacancy in the membership of the Local Authority Council	7
No. 321 Notice of vacancy in the membership of Otavi Village Council	7
No. 322 Swakopmund Town Planning Amendment Scheme No. 40	8
No. 323 Ongwediva Town Planning Amendment Scheme No. 5	8
No. 324 Municipal Council of Windhoek: Rental tariffs for the Khomasdal Market	8
No. 325 Permanent closure of Portion A of Erf 1847, Mondesa Extension 3, as a street	9
No. 326 City of Windhoek: Permanent closure of Portion A of Brug Street, Katutura as street (The portion is 801m ² in extent, and will be donated to the owner of Erf 9674, Katutura for consolidation purposes)	9
No. 327 City of Windhoek: Permanent closing of Portion A of the remainder of Erf 3081 Windhoek as public open space, (The portion is approximately 1 583m ² in extent). The portion will be sold to the owner of the remainder of Erf 2923, 4 Sauer Street Windhoek for consolidation purpose	10

No. 328	City of Windhoek: Permanent closing of Portion A of Erf 297 Doradopark as public open space, (Portion A is approximately 130m ² in extent). The respective portion will be sold to the owner of Erf 212 Doradopark, Taurus Street, for consolidation purpose	10
No. 329	City of Windhoek: Permanent closing of Portions A and B of Erf 4229 Khomasdal as public open space, (Portion A is approximately 150m ² and Portion B is 175m ² in extent). The respective portions will be sold to the owners of Erven 3997 and 3996 Khomasdal, Chrysler Street, for consolidation purpose	11
No. 330	Gibeon Village Council: Summary of applicable tariffs for 2009/2010	11
No. 331	Keetmanshoop Municipality: New tariffs for 2009/2010 (excluding VAT)	16
No. 332	Khorixas Town Council: General valuation of rateable properties situated within the Khorixas Local Authority Area	25
No. 333	Bank of Namibia: Statement of Assets and Liabilities as at close of business on 30 September 2009/25	
No. 334	Bank of Namibia: Statement of Assets and Liabilities as at close of business on 31 October 2009	26

Government Notices

MINISTRY OF REGIONAL AND LOCAL GOVERNMENT, HOUSING AND RURAL DEVELOPMENT

No. 229 2009

WINDHOEK TOWN PLANNING AMENDMENT SCHEME NO. 89: TOWN PLANNING ORDINANCE, 1954

In terms of subsection (2) of section 26 of the Town Planning Ordinance, 1954 (Ordinance No. 18 of 1954), I give notice that I have under subsection (1) of that section read with section 27(1) of that Ordinance, approved the Windhoek Town Planning Amendment Scheme No. 89 of the Municipality of Windhoek.

J. EKANDJO
**MINISTER OF REGIONAL AND
LOCAL GOVERNMENT, HOUSING
AND RURAL DEVELOPMENT**

Windhoek, 13 November 2009

MINISTRY OF REGIONAL AND LOCAL GOVERNMENT, HOUSING AND RURAL DEVELOPMENT

No. 230 2009

ONGWEDIVA TOWN PLANNING AMENDMENT SCHEME NO. 4: TOWN PLANNING ORDINANCE, 1954

In terms of subsection (2) of section 26 of the Town Planning Ordinance, 1954 (Ordinance No. 18 of 1954), I give notice that I have under subsection (1) of that section read with section 27(1) of that Ordinance, approved the Ongwediva Town Planning Amendment Scheme No. 4 of the Ongwediva Town Council.

J. EKANDJO
**MINISTER OF REGIONAL AND
LOCAL GOVERNMENT, HOUSING
AND RURAL DEVELOPMENT**

Windhoek, 13 November 2009

MINISTRY OF WORKS AND TRANSPORT

No. 231

2009

**NOTICE OF INTENDEND AMENDMENT OF TARIFF OF CONSULTING FEES
CHARGEABLE BY PROFESSIONAL ENGINEERS AND INCORPORATED
ENGINEERS: ENGINEERING PROFESSION ACT, 1986**

In terms of subsection (4) section 7 of the Engineering Profession Act, 1986 (Act No. 18 of 1986) I give notice on the recommendation of the Engineering Council of Namibia that -

- (a) I am considering to amend Government Notice No. 24 of 25 February 1993 by the substitution in regulations 2.3.4.1, 3.3.4.1 and 4.3.4.1 for wherever the amount of "N\$799.00" occurs of the amount "N\$890.00", after the expiry of a period of four weeks from the date of publication of this notice;
- (b) any interested person who wishes to make an objection or a presentation concerning that amendment contemplated in paragraph (a) is invited to submit his or her objection or to make his or her representation in writing to the Permanent Secretary, Ministry of Works and Transport, Private Bag 13341, Windhoek within a period of two weeks from the date of publication of this notice.

H. ANGULA**MINISTER OF WORKS AND TRANSPORT**

Windhoek, 20 November 2009

MINISTRY OF WORKS AND TRANSPORT

No. 232

2009

**MINIMUM FEES CHARGEABLE BY ARCHITECTS AND QUANTITY
SURVEYORS: ARCHITECTS AND QUANTITY SURVEYORS' ACT, 1979**

In terms of subsection (6) of section 7 of the Architects' and Quantity Surveyors Act, 1979 (Act No. 13 of 1979), it is made known that the Minister of Works and Transport has under paragraph (a) of subsection (3) of that section and on the recommendation of the Namibia Council for Architects and Quantity Surveyors -

- (a) prescribed that -
 - (i) a minimum fee of N\$890.00 per hour be chargeable by an architect or quantity surveyor for professional services rendered by him or her;
 - (ii) the minimum fee referred to in subparagraph (i) must increase by 10 percent per annum; and
 - (iii) each annual increment referred to in subparagraph (ii) must form the base value upon which the final annual increment has been calculated; and
- (b) repealed Government Notice No. 197 of 15 November 2006.

H. ANGULA**MINISTER OF WORKS AND TRANSPORT**

Windhoek, 20 November 2009

**MINISTRY OF REGIONAL AND LOCAL GOVERNMENT,
HOUSING AND RURAL DEVELOPMENT**

No. 233

2009

**ALTERATION OF BOUNDARIES OF THE LOCAL AUTHORITY AREA OF OPUWO:
LOCAL AUTHORITIES ACT, 1992**

Under section 4(1)(b) of the Local Authorities Act 1992, (Act No. 23 of 1992), I alter the boundaries of the local authority area of Opuwo, by adding Farm No. 1115 situated in the Registration Division "A", and represented by Cadastral Diagram A 798/2006, to the boundaries of Opuwo Townlands No. 876, as indicated in the diagram set out in Annexure 4 of Proclamation No. 6 of 3 March 1992.

Cadastral Diagram A 798/2006 shall lie open for inspection at the Office of the Surveyor-General, Windhoek, during office hours.

**J. EKANDJO
MINISTER OF REGIONAL AND
LOCAL GOVERNMENT, HOUSING
AND RURAL DEVELOPMENT**

Windhoek, 9 November 2009

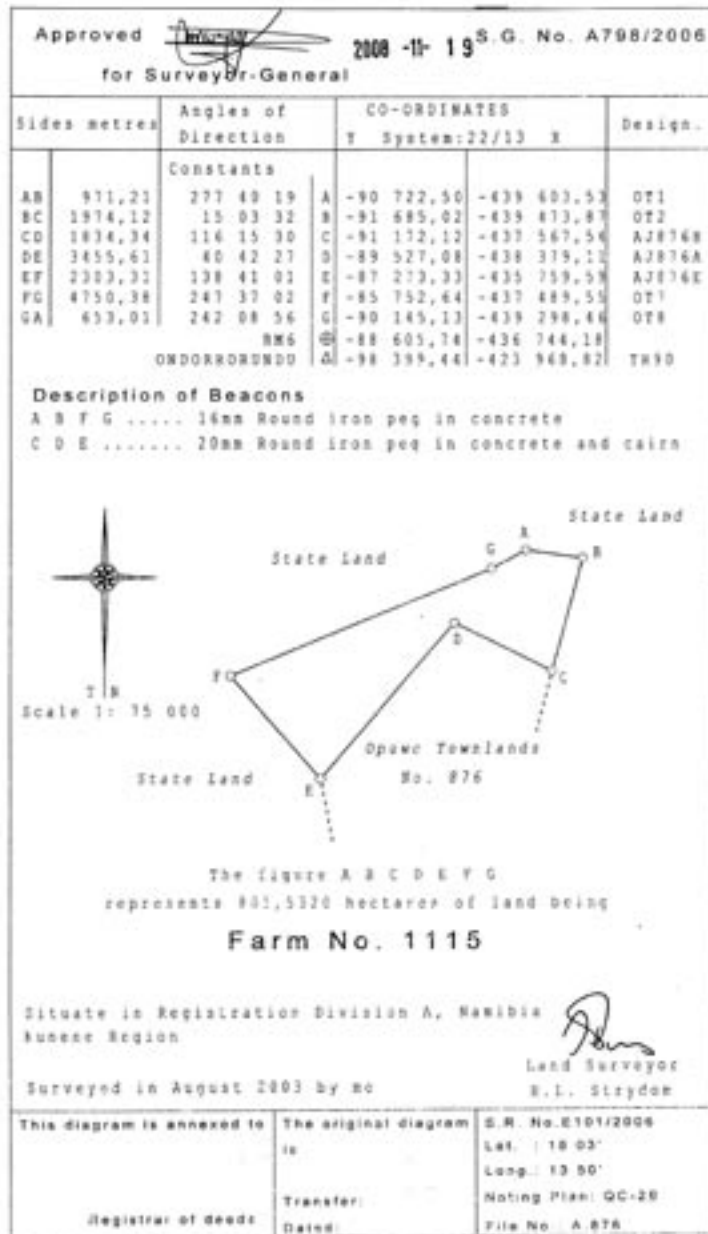

MINISTRY OF FINANCE

No. 234

2009

**REGULATIONS RELATING TO FEES PAYABLE TO BANK OF NAMIBIA:
BANKING INSTITUTIONS ACT, 1998**

Under section 71 of the Banking Institutions Act, 1998 (Act No. 2 of 1998), on the recommendation of the Bank of Namibia, I have, with effect from 31 December 2010.

- (a) made the regulations set out in the Schedule; and
- (b) repealed General Notice No. 75 of 1 April 1998.

S. KUUGONGELWA-AMADHILA
MINISTER OF FINANCE

Windhoek, 12 October 2009

SCHEDULE**Definitions**

1. In these regulations a word or expression defined in the Act has the same meaning, and -

“NISS” means Namibia Inter-bank Settlement System as defined in the Directive on the Conduct of EFT Transactions within the National Payment System (PSDIR -1) issued under the Payment System Management Act, 2003 (Act No. 18 of 2003); and

“the Act” means Banking Institutions Act, 1998 (Act No. 2 of 1998);

Fees payable in respect of applications, authorizations and approvals

- 2.** The fees payable to the Bank are -
- (a) for an application for authorization to establish N\$10 000;
a banking institution in terms of section 10
 - (b) for an authorization fee in terms of section 11(6) N\$5 000;
 - (c) for an application for approval of a representative N\$5 000.
office in terms of section 19

Annual fees payable by authorised banking institutions

3. (1) The annual fees payable by an authorized banking institution to the Bank in terms of section 13(1) is an amount equivalent to 0.001% of the banking institution's total non-bank deposit funds as at December of the previous year, rounded up to the nearest dollar, irrespective of the number of branches of such banking institution.

(2) The minimum annual fees payable by any banking institution is N\$20 000.

(3) A banking institution authorized after 31 January of any year to conduct banking business must, before the last day of the month during which it is so authorized and in respect of the period ending on 31 January of the following year, pay to the Bank an annual fee calculated in accordance with the following formula:

$$\frac{M}{12} \times \text{N\$}20,000$$

in which formula “M” represents the number of full months remaining up to 31 January of the following year, calculated from the date upon which the banking institutions was so authorized.

Methods of payment of fees

4. (1) Fees payable in accordance with these regulations must be paid to the Bank at its head office in Windhoek, and may be paid by cheque, postal order, money order, or electronic transfer through the NISS, made out in favour of or payable to the Bank, and no amounts so paid are refundable.

(2) In case of payments made by electronic transfer through the NISS, banking institutions must inform and submit proof of such payments to the Bank on or before 31 January of each year as prescribed by section 13(1) of the Act.

Penalty for late payment of fees

5. The penalty payable in terms of section 13(4) of the Act, in respect of every month or part thereof which the annual fees remain unpaid, must be calculated at a rate equal to 10% of the total annual fees payable by the banking institution concerned, and calculated from the final date upon which such annual fees became payable up to the date of the actual payment thereof.

MINISTRY OF HOME AFFAIRS AND IMMIGRATION

No. 235

2009

ALIENS ACT, 1937: CHANGE OF SURNAME

In terms of section 9(1) of the Aliens Act, 1937 (Act No. 1 of 1937), it is hereby made known that the Minister of Home Affairs and Immigration has under the said section authorized each person whose name and residential address appear in column 1 of the schedule hereto assume the surname mentioned in column 2 of the schedule opposite his or her name in column 1.

SURNAME	NAME (S)	RESIDENTIAL ADDRESS	SURNAME
Abraham	Rakker Johanna	PO Box 2459, Ondangwa	Hamukwaya
Absalom	Selma	PO Box 187, Omaruru	Iitana
Amuele	Amalia	PO Box 294 Uutapi	Tamuti
Andreas	Reinhold Tshagwana	Erf No. 2090/33, Opaal Street, Walvis Bay	Kamati
Elia	Paulus Ishuanga	PO Box 16043, Oshihole, Onesi	Kamati
Fillemon	Lydia	Private Bag 1001, Gibeon	Abraham
Gustaf	Filippus Nduuvundi	PO Box 22739, Windhoek	Iipingge
Herero	Gerhard	PO Box 1987, Hockland Park	Goraseb
Iileka	Petrus	PO Box 80521, Olympia, Windhoek	Vaino
Iileka	Helena	PO Box 23301, Pionerspark	Matias
Iyahula	Iyahula	Erf 1469, Wolk Street	Nelenge
Iyambo	Doroty Nuusiku	PO Box 2069, Oshakati	Abed
Johannes	Stefanus	PO Box 902, Ohangwena	Shatonhoka
Kisifofa	Ruusa	PO Box 2738, Windhoek	Nakuumba

Lötter	Rehuel Borstlap	PO Box 464, Otjiwarongo	Borstlap
Mahunzi	Easter Muzimbwa	PO Box 32 Katima Mulilo	Matongo
Matias	Lucia	PO Box 646, Ondangwa	Indongo
Mbaiza	Standliver Tau	PO Box 2164, Windhoek	Pack
Namwandi	Anna Ndilimeke	PO Box 22378, Windhoek	Kalola
Ngonga	Vilima Ndeutalala	Erf 974, Goriangab Dam	Kasheeta
Nkumbo	Johannes	PO Box 1772, Rundu	Max
Paulus	Titus	PO Box 2415, Oshakati	Shikongo
Salatiel	Lukas Twapwapo	Suiderhof Military Base	Gotlieb
Shigwedha	Lasarus	PO Box 15 Outapi, Ombalantu	Eita
Shigwedha	Foibe	Erf 7901, Klaudius Kandovazu Street, Katutura	Shaanika
Shimbutu	Petrus	PO Box 1133, Rundu	Kapumburu
Ugwanga	Desderius	PO Box 449, Grootfontein	Alumana

General Notices

MUNICIPALITY OF GROOTFONTEIN

No. 320

2009

NOTICE OF VACANCY IN THE MEMBERSHIP OF THE LOCAL AUTHORITY COUNCIL

In terms of section 13(1)(f) of the Local Authorities Act, 1992 (Act No. 23 of 1992) as amended, notice is hereby given that Councillor HP Botha has resigned as Councillor, as from the 1 October 2009.

Notice is hereby further given to the Republican Party of Namibia to nominate a member of the Local Authorities Council of Grootfontein within three months from the date of publishing of the notice.

C.K. KARIKO
ACTING CHIEF EXECUTIVE OFFICER
PO BOX 23
GROOTFONTEIN

OTAVI VILLAGE COUNCIL

No. 321

2009

NOTICE OF VACANCY IN THE MEMBERSHIP OF OTAVI VILLAGE COUNCIL

In terms of Section 13(1)(g) read together with Section 13(3) of the Local Authorities Act, 1992 (Act No. 23 of 1992), as amended, notice is hereby given that a vacancy has occurred in the membership of Otavi Village Council with effect from 1 September 2009, due to resignation of Councillor Kaunda Utale of Swapo Party.

Notice is hereby further given to Swapo Party in terms of section 13(4)(a) of the Local Authorities Act, 1992 (Act No. 23 of 1992) to nominate a member to the Otavi Village Council within three months from the date of publication of this notice.

E.S GAOAB
ACTING VILLAGE SECRETARY

No. 322

2009

SWAKOPMUND TOWN PLANNING AMENDMENT SCHEME NO. 40

Notice is hereby given in terms of Section 23 of the Town Planning Ordinance 1954, (Ordinance 18 of 1954), as amended, that the Swakopmund Town Planning Amendment Scheme No. 40, has been submitted to the Minister of Regional and Local Government, Housing and Rural Development for approval.

Copies of the Swakopmund Town Planning Amendment Scheme No. 40 and the maps, plans, documents and other relevant matters are lying for inspection during office hours at the Municipality of Swakopmund and also at the Namibia Planning Advisory Board (NAMPAB), Ministry of Regional and Local Government, Housing and Rural Development, 2nd Floor, Room 234, GRN Office Park, Windhoek.

Any person who wishes to object to the approval of Swakopmund Town Planning Amendment Scheme No. 40, should lodge objections in writing to the Secretary, Namibia Planning Advisory Board (NAMPAB), Private Bag 13289, Windhoek on/before 15 January 2010.

No. 323

ONGWEDIVA TOWN PLANNING AMENDMENT SCHEME NO. 5

Notice is hereby given in terms of Section 23 of the Town Planning Ordinance 1954, (Ordinance 18 of 1954), as amended, that the Ongwediva Town Planning Amendment Scheme No. 5, has been submitted to the Minister of Regional and Local Government, Housing and Rural Development for approval.

Copies of the Ongwediva Town Planning Amendment Scheme No. 5 and the maps, plans, documents and other relevant matters are lying for inspection during office hours at the Ongwediva Town Council and also at the Namibia Planning Advisory Board (NAMPAB), Ministry of Regional and Local Government, Housing and Rural Development, 2nd Floor, Room 234, GRN Office Park, Windhoek.

Any person who wishes to object to the approval of the Town Planning Scheme, should lodge objections in writing to the Secretary, Namibia Planning Advisory Board (NAMPAB), Private Bag 13289, Windhoek on or before 15 January 2010.

MUNICIPAL COUNCIL OF WINDHOEK

No. 324

2009

RENTAL TARIFFS FOR THE KHOMASDAL MARKET

The Council of the Municipality of Windhoek, under Section 30(1)(u) of the Local Authorities Act, 1992 (Act No. 23 of 1992), has determined the rental tariffs for the Khomasdal Market as set out in the Schedule below:

SCHEDULE

Stall description	Size (m²)	Rental rate/m² (N\$)	Month y rental (N\$)	VAT @ 15% (N\$)	Total per month (N\$)
Six (6) locable stalls	24	30.00	720.00	108.00	828.00
Four (4) locable stalls	19.8	30.00	594.00	89.10	683.10
Ten (10) open trading areas	4.4	-	60.50	9.08	69.58
Six (6) perimeter stalls	5.29	-	159.78	23.97	183.75
Six (6) barbeque stands (with barbegue rosters)	4.26	-	88.00	13.20	101.20

BY ORDER OF THE COUNCIL**M. K. SHIKONGO / CHAIRPERSON OF THE COUNCIL**

No. 325

2009

**PERMANENT CLOSURE OF PORTION A OF ERF 1847, MONDESA
EXTENSION 3, AS A STREET**

Notice is hereby given in terms of Section 50 of the Local Authorities Act, 1992 (Act No. 23 of 1992) that the Swakopmund Town Council proposes to permanently close Portion A of Erf 1847, Mondesa Extension 3 measuring $\pm 170\text{m}^2$ in extent as a Street. The proposed closure is to enable Council to sell Portion A of Erf 1847, Mondesa Extension 3 to the owner of Erf 1953, Mondesa Extension 3 (located adjacent to each other) for consolidation purposes.

**PERMANENT CLOSURE OF PORTION A OF ERF 1847, MONDESA
EXTENSION 3, AS A STREET**

Further, take note that a copy of the locality map of the proposed street closure as indicated on SPC Drawing No W/09103 is available for inspection during normal office hours at the offices of the Swakopmund Town Council.

Further take note that any person objecting against the permanent street closure as indicated above may lodge such objection together with the grounds thereof, with the Chief Executive Officer, Swakopmund Town Council and Stubenrauch Planning Consultants cc, in writing before Wednesday, 16th December 2009.

Applicant: Stubenrauch Planning Consultants cc
PO Box 11869
Windhoek
Tel: 061-251189

The Chief Executive Officer
Swakopmund Town Council
PO Box 53
Swakopmund

CITY OF WINDHOEK

No. 326

2009

**PERMANENT CLOSURE OF PORTION A OF BRUG STREET, KATUTURA AS STREET
(THE PORTION IS 801 M² IN EXTENT, AND WILL BE DONATED TO THE OWNER OF
ERF 9674 KATUTURA FOR CONSOLIDATON PURPOSES**

Notice is hereby given in terms of article 50(1)(a)(ii) of the Local Authorities Act, 1992 (Act No. 23 of 1992) that the City of Windhoek proposes to close permanent the undermentioned portion as

indicated on locality plan, which lies for inspection during office hours at the office of Urban Policy, Room 519, Municipal Offices, Independence Avenue.

PERMANENT CLOSURE OF PORTION A OF BRUG STREET, KATUTURA AS STREET
(THE PORTION IS 801 M² IN EXTENT, AND WILL BE DONATED TO THE OWNER OF
ERF 9674 KATUTURA FOR CONSOLIDATON PURPOSES)

Objections to the proposed closing are to be served on the Secretary: Townships Board, Private Bag 13289, and the Chief Executive Officer, P.O. Box 59, Windhoek, within 14 days after the appearance of this notice in accordance with Article 50 (3) (a)(iv) of the above Act.

B. MUTRIFA
URBAN PLANNER

CITY OF WINDHOEK

No. 327

2009

PERMANENT CLOSING OF PORTION A OF THE REMAINDER OF ERF 3081
WINDHOEK AS PUBLIC OPEN SPACE, (THE PORTION IS APPROXIMATELY
1 583M² IN EXTENT). THE PORTION WILL BE SOLD TO THE OWNER OF THE
REMAINDER OF ERF 2923, 4 SAUER STREET WINDHOEK FOR
CONSOLIDATION PURPOSE

Notice is hereby given in terms of article 50(1)(a)(ii) of the Local Authorities Act, 1992 (Act No. 23 of 1992) that the City of Windhoek proposes to close permanent the undermentioned portion as indicated on locality plan, which lies for inspection during office hours at the office of the Division: Urban Planning Room 519, Municipal Offices, Independence Avenue.

PERMANENT CLOSING OF PORTION A OF THE REMAINDER OF ERF 3081
WINDHOEK AS PUBLIC OPEN SPACE, (THE PORTION IS APPROXIMATELY
1 583M² IN EXTENT). THE PORTION WILL BE SOLD TO THE OWNER OF THE
REMAINDER OF ERF 2923, 4 SAUER STREET WINDHOEK FOR
CONSOLIDATION PURPOSE

Objections to the proposed closing are to be served on the Secretary: Townships Board, Private Bag 13289, and the Chief Executive Officer, P.O. Box 59, Windhoek, within 14 days after the appearance of this notice in accordance with Article 50 (1) (C) of the above Act.

B.N. MUTRIFA
URBAN PLANNER

CITY OF WINDHOEK

No. 328

2009

PERMANENT CLOSING OF PORTION A OF ERF 297 DORADOPARK AS PUBLIC
OPEN SPACE, (PORTION A IS APPROXIMATELY 130 M² IN EXTENT). THE
RESPECTIVE PORTION WILL BE SOLD TO THE OWNER OF ERF 212
DORADOPARK, TAURUS STREET, FOR CONSOLIDATION PURPOSE

Notice is hereby given in terms of article 50(1)(a)(ii) of the Local Authorities Act, 1992 (Act No. 23 of 1992) that the City of Windhoek proposes to close permanent the undermentioned portion as

indicated on locality plan, which lies for inspection during office hours at the office of the Division: Urban Planning Room 519, Municipal Offices, Independence Avenue.

PERMANENT CLOSING OF PORTION A OF ERF 297 DORADOPARK AS PUBLIC OPEN SPACE, (PORTION A IS APPROXIMATELY 130 M² IN EXTENT). THE RESPECTIVE PORTION WILL BE SOLD TO THE OWNER OF ERF 212 DORADOPARK, TAURUS STREET, FOR CONSOLIDATION PURPOSE

Objections to the proposed closing are to be served on the Secretary Townships Board, Private Bag 13289, and the Chief Executive Officer, P.O. Box 59, Windhoek, within 14 days after the appearance of this notice in accordance with Article 50(1)(C) of the above Act.

B.N. MUTRIFA
URBAN PLANNER

CITY OF WINDHOEK

No. 329

2009

PERMANENT CLOSING OF PORTIONS A AND B OF ERF 4229 KHOMASDAL AS PUBLIC OPEN SPACE, (PORTION APPROXIMATELY 150 M² AND PORTION B IS 175 M² IN EXTENT). THE RESPECTIVE PORTIONS WILL BE SOLD TO THE OWNERS OF ERVEN 3997 AND 3996 KHOMASDAL, CHRYSLER STREET, FOR CONSOLIDATION PURPOSE

Notice is hereby given in terms of article 50 (1) (a) (ii) of the Local Authorities Act, 1992 (Act 23 of 1992) that the City of Windhoek proposes to close permanent the undermentioned portion as indicated on locality plan, which lies for inspection during office hours at the office of the Division: Urban Planning Room 519, Municipal Offices, Independence Avenue.

PERMANENT CLOSING OF PORTIONS A AND B OF ERF 4229 KHOMASDAL AS PUBLIC OPEN SPACE, (PORTION APPROXIMATELY 150 M² AND PORTION B IS 175 M² IN EXTENT). THE RESPECTIVE PORTIONS WILL BE SOLD TO THE OWNERS OF ERVEN 3997 AND 3996 KHOMASDAL, CHRYSLER STREET, FOR CONSOLIDATION PURPOSE

Objections to the proposed closing are to be served on the Secretary: Townships Board, Private Bag 13289, and the Chief Executive Officer, P.O. Box 59, Windhoek, within 14 days after the appearance of this notice in accordance with Article 50(1)(C) of the above Act.

B.N. MUTRIFA
URBAN PLANNER

GIBEON VILLAGE COUNCIL

No. 330

2009

SUMMARY OF APPLICABLE TARIFFS FOR 2009/2010

The Gibeon Village Council has under section 30(1)(u) of the Local Authorities Act, 1992 (Act No. 23 of 1992) determined the tariffs and charges for the supply of services by the Village Council of Gibeon as out in the Schedule with effect from 1st July 2009.

Tariff Description	Note	Existing Tariff N\$ 2008/9	Proposed Tariff N\$ 2009/10	Increase %
Connection fees for water				
Conventional meters				
(a) Residential customers	20mm	600.00	600.00	0.00%
(b) All other customers	50mm +	Actual cost plus 15%		
Pre-Paid meters				
(a) Residential customers: Yard Meters	20mm	2,225.001	2225.00	0.00%
(b) All other customers	50mm +	Actual cost plus 15%		
Monthly Basic Charges				
(a) Residential Customers		45.00	47.25	5.00%
(b) All other customers		135.00	141.75	5.00%
Consumption Cost				
Residential	m ³	9.50	9.98	5.00%
Prepaid water -0-500	m ³	10.75	11.29	5.00%
Standpipe	m ³	15.50	15.50	0.00%
Extra Cost (All customers)				
Reconnection charges		50.00	50.00	0.00%
Reconnection and Disconnection charges on request		30.00	30.00	0.00%
ELECTRICITY TARIFFS				
Conventional meters				
Desposits on conventional meters				
(a) Residential Customers (Single phase)		300.00	300.00	0.00%
(b) Business: 1. Single phase		350.00	350.00	0.00%
2. Three phase		850.00	850.00	0.00%
Connection fees New applications				
Single Phase				
(a) Residential		315.00	315.00	0.00%
(b) Business		350.00	350.00	0.00%
Three Phase				
(a) Business		850.00	850.00	0.00%
(c) Large power user,		Actual cost plus 15%		
Monthly Basic Charges				
Per Ampere				
(a) Residential customers		3.60	4.25	18.00%
(b) Low user business		3.60	4.25	18.00%
(c) Medium user business 3 - phase up to 60 Amps		3.60	4.87	35.28%
(d) Large power users per Amp	3 x 60 plus	Maximum Demand Charges		
Energy Charges (per KWH unit)				
(a) Residential		0.80	0.96	20.00%
(b) Business		0.90	1.08	20.00%
(c) Large power users		0.90	1.08	20.00%
1. Reconnection and Disconnection charges		75.00	90.00	20.00%
2. Reconnection and Disconnection charges on request		30.00	30.00	0.00%

TESTING OF DEFECT METERS				
Consumer must pay deposit for testing of a meter:				
Testing of meter is free of charge, if found the meter is defect. In case of vandalism, fee amounts to actual cost is payable				
If found that a meter registered correctly, the customer must bear the actual cost of the testing				
TAMPERING/THEFT OF WATER/ELECTRICITY				
(a) First offence		2,000.00	2,000.00	0.00%
(b) Second offence (legal action to be taken)				
READYBOARD INSTALLATION				
Installation (without the meter whereby no house reticulation is involved, will be subject to the actual cost of installation plus 15% surcharge.				
PRE-PAID METERING				
Connection Fees:				
(a) Single phase pre-paid meter (residential)		1,790.00	1790.00	0.00%
(b) All other customers(actual cost +15% surcharge)		Actual cost plus 15%		
(c) Deposits on single phase: Monthly installment x 6		300.00	300.00	0.00%
ENERGY CHARGES (TARIFF PER KWH UNIT)				
Residential		0.85	1.02	20.00%
Business		0.90	1.08	20.00%
Sewerage Basic Charges (Waterborne Sewerage)				
(a) Residential customers per month		15.00	15.00	0.00%
(b) Business customer per month		25.00	25.00	0.00%
Sewerage Discharge per month (Waterborne Sewerage)				
(a) Residential (for each toilet)		10.00	10.00	0.00%
(b) Business (for each toilet)		20.00	20.00	0.00%
NEW SEWERAGE CONNECTION				
(a) Residential (Actual cost + 15% surcharge)				
(b) Business (Actual cost + 15% surcharge)				
NIGHT SOIL REMOVAL				
Removal per bucket per month		30.00	30.00	0.00%
REFUSE REMOVAL				
Removal per standard receptacle per month		30.00	30.00	0.00%
Removal of garden refuse on request		100.00	100.00	0.00%
Removal of Building Rubble per lorry and part thereof		150.00	150.00	0.00%
Delivery of sand/gravel garden soil per load		200.00	200.00	0.00%
SEWERAGE DUMP				
Removal per 1 Kilolitre or part thereof	m ³	30.00	30.00	0.00%
CEMETARY FEES AND CHARGES				
1. Reserved Grave space				
(a) For each grave space reserved		150.00	150.00	0.00%
(b) For each burial in reserved grave space		75.00	75.00	0.00%
2. Ordinary Grave Space				
(a) For persons over 18 years of age		125.00	125.00	0.00%
(b) For persons under 18 years of age		75.00	75.00	0.00%
(c) For persons 60 years and older and Disable persons		50.00	50.00	0.00%

3. Sundry Charges				
(a) Fees for exhumation of bodies:				
Re-opening and refilling grave, transfer and entering in a freshly prepared Grave, Altering registers etc.		250.00	275.00	10.00%
(b) For upkeep of grave (on application) as requested		30.00	50.00	66.67%
4. For the interment of a person who was not a resident or tax payer of Gibeon The prescribe amount plus 100% thereof.				
COMMONAGE				
Keeping of animals -Speculate	p/m per small stock p.d	0.50	0.50	0.00%
	p/m per large stock p.d	1.00	1.00	0.00%
RENT TOWNLANDS	p/m per small stock p.m	2.50	2.50	0.00%
	p/m per large stock p.m	3.50	3.50	0.00%
REGISTRATION OF BUSINESS				
Business Certificate shall be issued only upon the submission of a Fitness certificate annually				
(b) Certificate fees				
1. First registration				
2. Renewal				
		250.00	250.00	0.00%
3. Home based				
		200.00	200.00	0.00%
4. Hawkers				
	Per Month	15.00	15.00	0.00%
BUILDING PLANS				
Cost of building intended to be erected:-				
(a) Up to and including N\$ 25 000.00				
		35.00	35.00	0.00%
(b) Exceeding N\$ 25 000.00, N\$25.00 for first N\$ 25 000.00 and there after the N\$ 1.50 per N\$ 1 000.00 or part thereof.				
(c) In respect of any preliminary plans of any building intended to be erected which are submitted to the Local Authority for scrutiny, consideration and comment in terms of subregulation (3) the fee shall be N\$ 10.00				
			10.00	
Gravel -Building Sand Per m ³				
		35.00	35.00	0.00%
Rental of community hall per month				
(a) Rental of hall for events parties and weddings etc.				
Further to the above-mentioned fees a refundable deposit of N\$ 200.00 should be paid in case of any damage that may occur				
Rental soccer field per day or part of the day				
(a) Tournaments:				
		350.00	350.00	0.00%
(b) League Games				
		125.00	125.00	0.00%
(c) Friendly Games				
		60.00	60.00	0.00%
Further to the above-mentioned fees, a refundable deposit of N\$ 100.00 should be paid in case of any damage that may occur.				

POUNDAGE:				
Detention fees per day:-				
Large stock per day per head		25.00	25.00	0.00%
Small stock per day per head		5.00	5.00	0.00%
DOG TAX				
(a) Any dog other than a spayed bitch		15.00	15.00	0.00%
(b) Any unspayed bitch		25.00	25.00	0.00%
Driving Fees		5.00	5.00	0.00%
ASSESMENT RATES				
RESIDENTIAL				
(a) Site value N\$0,0559 per dollar per year		0.0600	0.0600	0.00%
(b) improvements value N\$0,0102 per dollar per year.		0.0115	0.0115	0.00%
BUSINESS				
(a) Site value N\$0,0559 per dollar per year		0.0650	0.0650	0.00%
(b) improvements value N\$0,0102 per dollar per year.		0.0125	0.0125	0.00%
RESIDENTIAL ERVEN				
Selling of Residential erven	m ²	4.00	4.00	
BUSINESS ERVEN				
Local Business	m ²		6.50	
Black Empowerment			8.00	
Investors			10.00	
INDUSTRIAL				
Across the board	m ²		12.00	
INSTITUTIONAL				
Churches 50% of development cost				
Other purchasers	m ²		8.00	
RENTALS OF DWELLINGS, PER MONTH OF PART OF A MONTH.				
(a) Type of dwellings: 1. Two rooms for Pensioners		66.13	66.13	0.00%
2. Two rooms others		132.25	132.25	0.00%
3. Your rooms Pensioners		132.25	132.25	0.00%
4. Your rooms others		304.18	304.18	0.00%
STATIONARY				
Duplicating				
Photocopies (a) A4		1.50	2.00	33.33%
(b) A3		2.20	2.50	13.64%
Communication				
Faxes: Received		5.00	5.00	0.00%
Send		5.00	5.00	0.00%
Miscellaneous				
Drain rods per day or part thereof		80.00	80.00	0.00%
Tractor per hour or part thereof		160.00	160.00	0.00%
Tipper per hour and part thereof		335.00	335.00	0.00%
JCB per hour and part thereof		275.00	275.00	0.00%
Water Tanker 1 Hour + 11 KM		175.00	175.00	0.00%

**BY ORDER OF THE GIBEON VILLAGE COUNCIL
CHAIRPERSON OF THE COUNCIL**

KEETMANSHOOP MUNICIPALITY

No. 331

2009

NEW TARIFFS FOR 2009/2010 (EXCLUDING VAT)

Municipal Council of Keetmanshoop is hereby giving a public notice as required by section 30(1)(u) of Act No. 23 of 1992 as amended by Section 20 (b) (aa, bb) of Act No. 24 of 2000 that the Council will charge fees and other monies payable by the public for any services, (amenity or facility established) rendered whether or not such services are being utilized by the natural and/or artificial/legal person. This is a council by-law and it should be regarded as such.

Further to the above, the Public Notice is with effect as from the 1st of July 2009.

1. WATER

	Existing tariffs	New tariffs
Basic - Residential per erf	N\$36.30	N\$40.00
Basic - Senior citizens	No charge	No charge
Basic - Non-Residential per erf	N\$155.85	N\$171.73
Units per cubic	N\$9.46	N\$10.22
Borehole bulk supply (at borehole) per m3	N\$4.40	N\$6.11
Connection Fee - new per connection	N\$160.00	N\$172.80
Connection Fee - Suspensions per connection	N\$150.00	N\$162.00
Deposit - Residential per erf (average method only if average consumption is above deposit paid)	N\$280.00 and average method after three months	N\$300.00 and average method after three months
Deposit - commercial per consumer	N\$560.00	N\$600.00
Fines-illegal connection, bypass, tampering, sabotage per incident	N\$2000.00	N\$2000.00
Interest on arrears (%)	19%	19.0%
Test meter (request) Watermeter rentals (Only new connections as well as subst of existing meters.) Penalty for damage/theft or loss of watermeter	N\$75.00	N\$75.00 N\$42-00 pm Full price of meter plus N\$200.00

2. SEWERAGE:

	Existing tariffs	New tariffs
Sewerage - Residential per toilet	N\$36.75	N\$40.00
Sewerage - For senior citizens	N\$15.75	N\$15.75
Sewerage - Commercial per toilet	N\$52.50	N\$57.14
Abattoirs (excluding toilets)	N\$75.00	N\$81.63

3. BUILDING CONTROL: APPROVAL OF PLANS

	Existing tariffs	New tariffs
Less than N\$4,999.00 per plan	N\$30.00	N\$35.00
N\$5,000.00 - N\$4,999.00 per plan	N\$50.00 + N\$1.00 per each N\$550.00	N\$55.00 + N\$1.00 per each N\$500.00

Small works (pools; walls; braai places etc.) separate and additional	N\$350.00	N\$350.00
Size 0 to 39 sqm per plan N\$10 000 - N\$24 999 per plan	N\$300 N\$65 1200 + 1.30 per each next N\$550 N\$500.00	N\$300.00 N\$65.00 1200 + 1.30 per each next
Size 40 to 59 sqm per plan	N\$580.00	N\$600.00
More than N\$25 000 per plan	N\$1600.00	N\$1600.00
Size 60 to 89 sqm per plan	N\$640.00	N\$640.00
Size 90 to 119 per plan	N\$720.00	N\$750.00
Size 120 to 159 per plan	N\$1050.00	N\$1100.00
Size 150 to 499 sqm per plan	N\$1540.00	N\$1600.00
Size 500 sqm or more per plan	N\$3500.00	N\$3800.00
Renewal plan (after expiry) per plan	N\$150.00	N\$200.00
Renewal of plan (after expiry) per sqm (per plan)	N\$7.30	N\$8.00
Re-inspection of plan/site per inspection	N\$100.00	N\$150.00
Scheme houses (mm. of 10 incidental type houses)	First plan as above and N\$308.00 per copy	First plan as above and N\$350.00 per copy
Penalties for illegal buildings/structures (per building/ structure)	N\$2500.00	N\$2,000.00
Building Inspections		N\$200.00

4. PRINTING OF PLANS AND MAPS:

	Existing tariffs	New tariffs
Drawing of Diagram/man sheet or Bldg Plan		
per copy	N\$26.60	N\$30.00
Copy of erf diagram A4/A3 per copy	N\$3.30	N\$3.50
Building Plan Copies A4/A3 per copy	N\$15.30	N\$25.00
Building Plan Copies A2/A0 per copy	N\$146.40	N\$160.00
Town Maps - A4/A3 per copy	Cost of supply + 25%	Cost of supply + 25%
Town Maps - A4/A0 per copy	Cost of supply + 25%	Cost of supply + 25%

5. HIRE OF PLANT AND EQUIPMENT:

	Existing tariffs	New tariffs
Bulldozer (incl. Oper.; excl. diesel) per hour	N\$600.00	N\$1000.00
Motor Graders per hour	N\$500.00	N\$1000.00
Wheel loaders per hour	N\$500.00	N\$800.00
Compressors (any compressor type) (incl. 2x Jack hammers; excl. oper + diesel per hour	N\$150.00	N\$800.00
Grid Roller and Tractor per hour	N\$400.00	N\$1000.00
Vibrator roller per hour	N\$400.00	N\$500.00
Tire roller per day	N\$1000.00	N\$1200.00
Tractor per hour	N\$350.00	N\$800.00
Tipper Truck per hour	N\$400.00	N\$800.00
Water Tanker/Truck per hour	N\$400.00	N\$800.00
Water Trailer per hour	N\$400.00 + N\$8.00/km	N\$500.00 + N\$9.00/km

Boomer Hoist per hour	N\$300.00	N\$400.00
Bomag per hour	N\$150.00	N\$300.00
Horse + Lowbed (town only) per hour / km	N\$400.00 + N\$12/ km	N\$600.00 + N\$12/ km

6. RENTING OF TOOLS

	Existing Tariffs	New tariffs
Loud speaker (PA System) per event/per day Not for hire	Not for hire	Not for hire
Megaphone per event/per day	Not for hire	Not for hire
Laser Beam per hour	N\$50.00	N\$50.00
Bolder buster (without cartridges) per hour	N\$50.00	N\$50.00
Scaffolding frames per day hour frame	N\$25.00	N\$50.00

7. PUBLIC HEALTH

	Existing tariffs	New tariffs
Sanitation: Garden refuse per tip truck- debited to account/pay cash if no account	N\$80.00	N\$100.00
Sanitation: Domestic Refuse per bin	N\$73.50	N\$73.50
Sanitation: Senior citizens	N\$40.00	N\$40.00
Commercial Refuse as follows: Shebeens	N\$175.00	N\$200.00
Commercial Refuse as follows: Business using (1 - 2 bins)	N\$175.00	N\$200.00
Commercial Refuse as follows: Businesses using (3-5 bins)	N\$388.50	N\$420.00
Commercial Refuse as follows: Businesses using (5-10 bins)	N\$750.00	N\$800.00
Commercial Refuse as follows: Businesses using (10 bins and more)	N\$750.00 + per bin	N\$800.00 + N\$200 per bin
Commercial Refuse as follows: Non-profit oriented Organisations	N\$200.00	N\$200.00 + N\$100 per bin
Commercial Refuse as follows: Illegal dumping - removal of waste	N\$2000.00	N\$2000.00
Call out of Health Inspector per call	Cost of supply + 30%	Cost of supply + N\$200 + km fee
Pest control (insects etc.) per call	Cost of control substance/supply +30%	Cost of control substance/supply +N\$200+km fee
Any other not listed above will be charged similar to item closely related to it, if not..	Council reserve the rights to introduce charges any time	Council reserve the rights to introduce charges anytime

8. ABATTOIR

	Existing tariffs	New tariffs
Inspection fee - Cattle per carcass	N\$11.50	N\$15.00 inspection outside town + km fee.
		N\$15.00 inside town + km fee
Inspection fee - Sheep/goat	N\$3.25	N\$4.50 outside town + km fee
		N\$4,50 inside town + km fee
Inspection fee - pigs	N\$6.00	N\$8.00 + km fee

Destruction of carcasses - Cattle per carcass	N\$340.00	N\$350.00 + km fee
Destruction of carcasses - Sheep per carcass	N\$240.00	N\$240.00 + km fee
Destruction of carcasses - Pigs per carcass	N\$240.00	N\$240.00 + km fee
Transport only for abattoir outside CBD		
Transport/travel per km	N\$6.50	N\$ 6.00 + km fee

9. GRAVE SPACE

	Existing tariffs	New tariffs
Central Adult - Row grave (Loopgraf)	N\$840.00	N\$840.00
Central Adult - Build out	N\$1932.00	N\$1932.00
Central Adult - Double	N\$2572.00	N\$2572.50
Central Child - Row grave (Loopgraaf)	N\$630.00	N\$630.00
Central Child - build out	N\$1228.50	N\$1228.50
Central Any extra municipal service rendered for all of the above	N\$250.00	N\$250.00
New Town cemetery: Same as Kronlein fees	N\$500-00	N\$400,00
Separate Block graves-family dig grave themselves		
Kronlein Adult - Standard	N\$770.00	N\$770.00
Kronlein Adult Build out	N\$1840.00	N\$1,840.00
Kronlein Adult Double	N\$2450.00	N\$2,450.00
Kronlein Child Row grave (Loopgraaf)	N\$580.00	N\$580.00
Kronlein Child build out	N\$1170.00	N\$1,170.00
Any extra municipal service rendered for all of the above	N\$250.00	N\$250.00
Tseiblaagte Adult - Standard	N\$610.00	N\$610.00
Tseiblaagte Child - Standard	N\$231.00	N\$231.00
Tseiblaagte Adult - Build out	N\$1840.00	N\$1840.00
Tseiblaagte Child - build out	N\$1170.00	N\$1170.00
Double, deep (AIDS victims only) -	free 20 graves, Limited 20 per annum only	free 20 graves, Limited 20 per annum only
Any extra municipal service rendered for all of the above	N\$250.00	N\$250.00

10. FITNESS CERTIFICATE

	Existing tariffs	New tariffs
Category 1: Hawkers	N\$150.00	N\$150.00 per annum
Category 1: Shebeens registration	N\$350.00	N\$350.00
Category 1: Home based business and stalls		N\$300.00
Category 2: Smaller general dealers (<10 employees)	N\$350.00	N\$350.00
Category 2: Big general dealers (>10 employees)	N\$420.00	N\$450.00
Category 2: Supermarkets and furniture shops	N\$630.00	N\$650.00
Category 2: Warehouses and stores	N\$630.00	N\$650.00
Category 2: Hotels, lodges and other accommodations	N\$420.00	N\$450.00
Category 2: Other smaller food outlets	N\$350.00	N\$350.00
Category 2: Service stations, garages and other oil depots	N\$700.00	N\$700.00
Category 2: Abattoirs	N\$800.00	N\$800.00

Category 2: Professionals and other office run-organisations (with less than 10 employees)	N\$350.00	N\$350.00
Category 2: Professionals and other office run-organisations (with more than 10 employees), incld. para-statals	N\$350.00	N\$350.00
Category 2: Noxious industry businesses	N\$800.00	N\$800.00
Category 2: Bottle stores and Bars	N\$500.00	N\$500.00
Category 2: Late registration for all	Normal registration + N\$15.00/late day	Normal registration + N\$15.00/late day
Animal Control: Dogs registration	N\$30.00	N\$30.00
Animal Control: Bitches (unsterilised)	N\$50.00	N\$50.00
Pound Fees Show Grounds - rent boxes and kraals: Animal Stalls: Large Stock per event/day Deposit	N\$3.00 p/day 50% of total fees payable	N\$3.00 p/day 50% of total fees payable
Pound Fees Show Grounds - rent boxes and kraals: Animal Stalls: Small Stock Unit per event/day Deposit	N\$2.00 p/day 50% of total fees payable	N\$2.50 50% of total fees payable

11. DETENTION FEES

	Existing tariffs	New tariffs
Large stock per day	N\$40.00	N\$40.00
Small Stock per day	N\$20.00	N\$20.00
Haulage (catching of animals) per animal	N\$350.00	N\$350.00
Grazing (camps): All animals except sheep or goat		
Grazing (camps): Commercial Farmers as per Tender	Minimum of N\$75.00	Minimum of N\$75.00
Grazing (camps): Communal Farmers per large stock/month	N\$6.00	N\$6.00
Feeding Large Stock per day	N\$15.00	N\$20.00
Feeding : Small Stock per day	N\$10.00	N\$10.00
Drinking Fee: Per animal per day	N\$7.00	N\$7.50
Drinking Fee: Ramkrale per sheep/goat per day	N\$8.00	N\$8.00

12. LEASE OF PROPERTIES

	Existing tariffs	New tariffs
Council houses: Tseiblaagte: Old houses		
• One-bed room	N\$200.00	N\$220.00
• Two-bed room	N\$250.00	N\$275.00
• Senior citizen (any house above)	N\$100.00	N\$100.00
Council houses: Tseiblaagte: New extension houses:		
• Two-bed room	N\$450.00	N\$495.00
• Three-bed room	N\$500.00	N\$550.00
S-houses:		
• Two-bed room	N\$300.00	N\$330.00
Single quarter:		
• One-bed room N\$100.00 (pensioners only otherwise N\$200.00)	N\$100.00	N\$100.00
Kronlein:		
• Outelein houses	N\$300.00	N\$330.00
• Outelein for senior citizens	N\$75.00	N\$75.00
Old council houses (Mimosa street)		
• Two-bed-rooms	N\$300.00	N\$330.00
• Senior citizens (Mimosa house)	N\$150.00	N\$150.00

Town, Tseiblaagte and Westdene		
Post-bound houses		
• Three-bed rooms	N\$800.00	N\$950.00
Care taker houses		
• One-bed-room	N\$150.00	N\$180.00
• Two-bed-room	N\$200.00	N\$250.00
Non-Post bounds		
• Three-bed rooms	N\$1300.00	N\$1800.00
Commercial Rentals:		
• Prime Area (CBD)	N\$28.75 per square meter	N\$32.00 per square meter
• Outside prime area (Outside CBD) including all suburbs	N\$20.15 per square meter	N\$22.50 per square meter
• Commercial -unserviced	N\$12.10 per square meter	N\$12.50 per square meter

13. RENTING OF PUBLIC FACILITIES

Show Hall	Existing tariffs	New tariffs
Fees per day (including chairs)	N\$1250	N\$1250.00
Deposit per booking	50% fees payable 50% fees payable	
Overnight Group per person per night	N\$30.00	N\$30.00
Deposit on above	50% of fees payable	50% of fees payable
Beer garden		
Per day per event	N\$750.00	N\$500.00
Deposit for booking	50% fees payable	50% fees payable
Moth Hall		
Fees per day per event (including chairs)	N\$1500.00	N\$1500.00
Deposit for any booking	50% of fees payable	50% of fees payable
W. K. Röver Hall		
Fees per day (all inclusive: i.e. chairs, sales stall)	N\$750.00	N\$800.00
Deposit for booking	50% of fees payable	50% of fees payable
Overnight Group per person per night	N\$15.00	N\$15.00
Deposit for any booking	50% fees payable	50% fees payable
Community meetings, church events, Cult Drps	N\$150-00	N\$150-00
Stadiums		
Hiring out of any stadium for league per day	N\$400.00	N\$400.00
Hiring out of any stadium for tournaments/day	N\$750.00	N\$750.00
Deposit for any booking above	50% fees payable	50% fees payable
Schools		
Fees per day	N\$250.00	N\$250.00
Deposit for booking above	N\$250.00	N\$250.00
NOTE: All advance bookings are subject to immediate full payment with 50% non-refundable in case of cancellation		
Other		
Flags, Video camera and PA system	Not to be hired out	Not to be hired out
Chairs	Not to be hired out	Not to be hired out
Red carpet	Not to be hired out	Not to be hired out

Stage	Not to be hired out	Not to be hired out
Plants	Not to be hired out	Not to be hired out

14. SWIMMING POOL

	Existing tariffs	New tariffs
Admission - Adult - weekdays	N\$8.00	N\$8.50
Admission - Adult - week-end/publ. Hol.	N\$10.50	N\$10.50
Admission - Child Weekdays	N\$4.00	N\$4.00
Admission - Child - week-end/publ. Hol.	N\$5.50	N\$6.00
Admission - Adult - Seasonal card	N\$250.00	N\$300.00
Admission - Child - Seasonal card	N\$100.00	N\$150.00
Rent - after hours (only) per event per day	N\$500.00	N\$800.00
Overtime for personnel per event per day	N\$400.00	N\$400.00
Leasing of Kiosk per season	N\$500.00	N\$500.00

15. CARAVAN PARK

	Existing tariffs	New tariffs
Admission - Adult	N\$50.00	N\$50.00
Admission - Child	N\$20.00	N\$20.00
Admission - Vehicle (per vehicle)	N\$20.00	N\$20.00
Use of showers is free	Free of charge	Free of charge
Rental for functions (per day)		N\$500-00

16. MISCELLANEOUS SERVICES

	Existing tariffs	New tariffs
Traffic Escort per day	N\$350.00	N\$400.00
Fire Brigade levy (per property)	N\$10.20	N\$10.50
Fire Brigade per call outside town	N\$10 per/km + fuel + cost of personnel	N\$10.00 per/km + fuel+ cost of personnel
Jaws of live		N\$200-00 p/h

17. TENDER DOCUMENTS

	Existing tariffs	New tariffs
N\$10,000 - N\$100,000	N\$150.00	N\$175.00
N\$100,001 - N\$500,000	N\$275.00	N\$300.00
N\$500,001 - N\$1,000,000	N\$325.00	N\$350.00
N\$1,000,001 - N\$1,500,000	N\$375.00	N\$400.00
N\$1,500,001 - N\$5,000,000	N\$425.00	N\$450.00
N\$5,000,001 and more	N\$525.00	N\$550.00
Copy extract of Council Minutes per document	N\$100.00 + 1.50/page	N\$100 + 2.50/page
Clearance certificate per certificate	N\$50.00	N\$75.00
Valuation certificate	N\$40.00	N\$50.00
Photo Copy A4	N\$2.00	N\$2.50
Photo Copy A3	N\$3.50	N\$5.50

18. PRICES OF SERVICED ERVEN: RESIDENTIALS

	Existing tariffs	New tariffs
Westdene:		
Normal residential	N\$13.80/m ²	N\$22.00/m ²
Commercial institutions (for business)	N\$21.50/m ²	N\$28.70/m ²
Non-Commercial institutions (for category business)	N\$20.50/m ²	N\$27.80 /m ²
New suburb for Westdene:		
Normal residential	N\$40.25/m ²	N\$45.00/m ²
Commercial institutions (for business)	N\$74.75/m ²	N\$78.00/m ²
Business erf	N\$86.25/m ²	N\$86.25/m ²
Noordhoek:		
Normal residential	N\$12.00/m ²	N\$20.34/m ²
Commercial institutions (for business)	N\$16.50/m ²	N\$24.25/m ²
Non-commercial institutions (for category business)	N\$14.50/m ²	N\$22.50/m ²
Business erf	N\$63.50/m ²	N\$65.00/m ²
Town:		
Normal residents	N\$14.60/m ²	N\$22.65/m ²
Commercial institutions (for business)	N\$ 34.50/m ²	N\$ 39.95/m ²
Non-commercial institutions (for category business)	N\$ 21.60/m ²	N\$ 28.80/m ²
Kronlein:		
Normal residents	N\$10.50/m ²	N\$19.00/m ²
Commercial institutions (for business)	N\$ 12.60/m ²	N\$ 20.90/m ²
Non-Commercial institutions (for category business)	N\$ 11.30/m ²	N\$ 19.75/m ²
Tseiblaagte:		
Normal residents	N\$10.20/m ²	N\$15.20/m ²
Commercial institutions (for business)	N\$11.20/m ²	N\$16.20m ²
Non-Commercial institutions (for category business)	N\$10.70/m ²	N\$15.70/m ²
Informal settlement:		
Lease per erf (all included except refuse and water basic and consumption)	N\$150.00/month	N\$150.00/month

19. PRICES OF SERVICED ERVEN: BUILD TOGETHER PROGRAMME

	Existing tariffs	New tariffs
Tseiblaagte:		
Old suburbs	N\$8.30/m ²	N\$8.50/m ²
New suburb	N\$9.80/m ²	N\$10.00/m ²
Kronlein:	N\$9.60/m ²	N\$11.00/m ²

20. PRICES OF SERVICED ERVEN: BUSINESS

	New tariffs	Existing tariffs
Tseiblaagte:	N\$24.80/m ²	N\$26.50/m ²
Kronlein:	N\$33.10/m ²	N\$38.75/m ²
Town:	N\$57.90/m ²	N\$70.35/m ²
Industrial erven:	N\$53.25/m ²	N\$70.00/m ²

21. ASSESSMENT RATES

	Existing tariffs	New tariffs
Tseiblaagte:		
Land Value	0.115 cents per N\$	0.120 cents per N\$
Improvement Value	0.012 cents per N\$	0.015 cents per N\$
Penalties:	Existing tariffs	New tariffs
No improvement: 2 - 3 years	As per Act	As per Act
No improvement: 3 years and more	As per Act	As per Act
Kronlein:		
Land Value	0.119 cents per N\$	0.124 cents per N\$
Improvement Value	0.012 cents per N\$	0.015 cents per N\$
Penalties:		
No improvement: 2 - 3 years	As per Act	As per Act
No improvement: 3 years and more	As per Act	As per Act
Noordhoek:		
Land Value	0.127 cents per N\$	0.132 cents per N\$
Improvement Value	0.013 cents per N\$	0.016 cents per N\$
Penalties:		
No improvement: 2 - 3 years	As per Act	As per Act
No improvement: 3 years and more	As per Act	As per Act

22. TOWN INCLUDING INDUSTRIAL AREA

	Existing tariffs	New tariffs
Land Value	0.130 cents per N\$	0.135 cents per N\$
Improvement Value	0.013 cents per N\$	0.016 cents per N\$
Penalties:		
No improvement: 2 - 3 years	As per Act	As per Act
No improvement: 3 years and more	As per Act	As per Act
Westdene:		
Land Value	0.133 cents per N\$	0.138 cents per N\$
Improvement Value	0.013 cents per N\$	0.016 cents per N\$
Penalties:		
No improvement: 2 - 3 years	As per Act	As per Act
No improvement: 3 years and more	As per Act	As per Act
Small Holdings:		
Land	0.088 cents per N\$	0.088 cents per N\$
Improvement	0.009 cents per N\$	0.009 cents per N\$
Penalties:		
No improvement: 2 - 3 years	As per Act	As per Act
No improvement: 3 years and more	As per Act	As per Act
UNDEVELOPED LAND FOR MORE 12 MONTHS	Minimum building value	Minimum building value
Valuation roll		N\$500,00 per hard copy

23. LEASES: BILLBOARDS

	Existing tariffs	New tariffs
Sign Boards: less than 2 sqr meters	N\$200.00/month	N\$200/month

BillBoards 2-3.9 sqr meters	N\$450.00/month	N\$450.00/month
BillBoards 4-8.9 sqr meters	N\$500.00/month	N\$500.00/month
BillBoards 9-17.8 sqr meters	N\$1300.00/month	N\$1300.00/month
BillBoards 18 sgm and more	N\$1500.00/month	N\$1500.00/month
Electrical illuminated light boxes	N\$300.00/month	N\$450.00/month
Street pole adverts per advert		N\$60.00 per ad/ month
Other:		
Sport ground advertisements	N\$600.00 p.a.	N\$500.00/p.a.
Fire wall advertisements	N\$600.00 p.a.	N\$200.00/p.a.
Banners across the road	N\$15.00/day + own installation	N\$25.00/day + own installation
Other small banners	A once-off N\$50.00 + own installation	A once-off N\$50.00 + own installation

BY ORDER OF COUNCIL**HIS WORSHIP THE MAYOR B. J. BROWN****KHORIXAS TOWN COUNCIL**

No. 332

2009

**GENERAL VALUATION OF RATEABLE PROPERTIES SITUATED
WITHIN THE KHORIXAS LOCAL AUTHORITY AREA**

Notice is hereby given in terms of the provisions of section 66(1) of the Local Authorities Act, 1992 (Act No. 23 of 1992) as amended, that a general valuation of all rateable properties situated within the Khorixas Local Authority Area will be carried out as from 1st January 2010 in accordance with the provisions and stipulations contained in section 67 to 72 inclusive of the Local Authorities Act, 1992 (Act No. 23 of 1992).

**N. #GAESEB
CHIEF EXECUTIVE OFFICER**

BANK OF NAMIBIA

No. 333

2009

**STATEMENT OF ASSETS AND LIABILITIES
AS AT CLOSE OF BUSINESS ON 30 SEPTEMBER 2009**

	30-09-09	31-08-09
	N\$	N\$
ASSETS		
External:		
Rand Cash	120,260,334	56,842,475
IMF - Special Drawing Rights	1,519,488,779	1,231,256,745

Investments	- Rand Currency	6,142,496,800	6,764,867,824
	- Other Currency	6,974,430,790	6,972,906,685
	- Interest Accrued	83,489,141	101,451,156
Domestic:			
Currency Inventory Account		54,550,435	54,490,072
Loans and Advances: Other		118,213,757	31,083,526
Fixed Assets		164,562,403	163,665,753
Other Assets		141,634,624	133,575,166
		15,319,127,063	15,510,139,402
LIABILITIES			
Share capital		40,000,000	40,000,000
General Reserve		595,699,214	595,699,214
Revaluation Reserve		879,464,357	1,152,225,905
Building Reserve		80,000,000	80,000,000
Currency in Circulation		1,548,140,462	1,586,283,616
Deposits:	Government	7,926,028,134	8,147,373,727
	Bankers - Reserve	384,546,856	376,598,729
	Bankers - Current	67,909,962	98,800,064
	Bankers - Call	330,928,697	279,346,706
	Other	3,187,809,624	2,862,849,797
Other Liabilities		278,599,757	290,961,644
		15,319,127,063	15,510,139,402

TOM ALWEENDO
GOVERNOR

ESTELLE TJIPUKA
CHIEF FINANCIAL OFFICER

BANK OF NAMIBIA

No. 334

2009

STATEMENT OF ASSETS AND LIABILITIES
AS AT CLOSE OF BUSINESS ON 31 OCTOBER 2009

		31-10-09	31-08-09
		N\$	N\$
ASSETS			
External:			
Rand Cash		156,570,240	120,260,334
IMF - Special Drawing Rights		1,604,455,722	1,519,488,779
Investments	- Rand Currency,	5,023,533,283	6,142,496,800
	- Other Currency	9,101,760,741	6,974,430,790
	- Interest Accrued	97,537,479	83,489,141

Domestic:

Currency Inventory Account	55,580,633	54,550,435
Loans and Advances: Other	249,070,393	118,213,757
Fixed Assets	161,126,657	164,562,403
Other Assets	154,707,917	141,634,624
	16,604,343,065	15,319,127,063

LIABILITIES

Share capital	40,000,000	40,000,000
General Reserve	595,699,214	- 595,699,214
Revaluation Reserve	1,328,199,764	879,464,357
Building Reserve	80,000,000	80,000,000
Currency in Circulation	1,558,227,888	1,548,140,462
Deposits: Government	8,606,363,286	7,926,028,134
Bankers - Reserve	388,502,733	384,546,856
Bankers - Current	377,848,344	67,909,962
Bankers - Call	46,116,271	330,928,697
Other	3,298,271,411	3,187,809,624
Other Liabilities	285,174,154	278,599,757
	16,604,343,065	15,319,127,063

TOM ALWEENDO
GOVERNOR

ESTELLE TJIPUKA
CHIEF FINANCIAL OFFICER